

Corporate Solutions Brochure

*Award-Winning Audio-Visual
Solutions Manufacturer*



Table of Contents

- About WyreStorm
- Case Studies
- Meeting Room Solutions
- Training Room Solutions
- Lobby Solutions
- Exhibition Hall Solutions
- Executive Room Solutions
- Contact Us

About WyreStorm

WyreStorm, established in 1994 in Memphis, Tennessee, is a leading manufacturer of A/V signal management and unified collaboration solutions for both commercial and residential markets. With 50+ prestigious awards and strong partnerships with industry leaders like HDMI, HDBaseT, and SDVoE, our products are trusted in education, luxury homes, corporate settings, and sports arenas.

WyreStorm solutions are **Powerful. Reliable. Simple.**

Benefits



Clear, Unbiased
Advice



Tailored
Solutions



Award Winning
Manufacturer



Global Network
of Offices



3 3 international offices in the
US, EU, and China Mainland



70+ Sales Network in over 70
countries and regions



35% 35%+ employees are R&D
personnel



50+ 50+ global trade awards
for products and projects



24/7 24x7 technical support &
local services



100% 100% international brand,
globalization & localization





WyreStorm Corporate Solutions

In today's fast-paced corporate environment, time is a critical asset. WyreStorm's corporate solutions are designed to provide unmatched clarity and efficiency, whether you are presenting ideas, engaging with clients, or conducting virtual conferences. Our offerings, ranging from secure ProAV signal distribution to advanced Unified Communications, ensure seamless, high-quality communication across all applications. Whether tailored for large-scale installations or professional boardrooms, WyreStorm's adaptable solutions optimize meeting workflows, fostering success and enhancing productivity in every interaction.

Solution	Key Features	Main Products
Meeting Room Solutions	<ul style="list-style-type: none"> - Seamless collaboration with flexible layouts - High-quality audio and video capabilities 	SW-640L-TX-W Wireless Presentation System, Halo 60 Conference Speakerphone, MX-0402-MST Conference Room Switcher, NHD-510-TX Encoder, NHD-500-RX v2 Decoder
Training Room Solutions	<ul style="list-style-type: none"> - Advanced facilities for interactive sessions 	MX-0804-EDC Presentation Matrix, NHD-510-TX Encoder, NHD-500-RX v2 Decoder
Lobby Solutions	<ul style="list-style-type: none"> - Flexible layouts for video wall configurations 	SW-0206-VW 4K Video Wall Processor
Exhibition Hall Solutions	<ul style="list-style-type: none"> - Scalable for large spaces 	NHD-120 Encoder & Decoder, NHD-150 MultiView Processor
Executive Room Solutions	<ul style="list-style-type: none"> - Wireless presentation for effortless collaboration 	SW-640L-TX-W Wireless Presentation System, HALO VX-10 All-in-One Mics



A background photograph of a diverse group of business professionals in a meeting room. A woman with curly hair is leaning over a desk, smiling at a woman with glasses who is looking at a laptop. Two men in suits are also looking at the laptop, one with his hand on his chin. The room has large windows and a bookshelf in the background.

Meeting Room Solutions

These solutions are specifically designed to provide an optimal audio-visual environment for meetings, collaborations, and presentations. Whether for small teams or large conferences, they offer a comprehensive setup that ensures high-quality video and audio performance, with flexibility for various room configurations and seating arrangements. The selected equipment supports multiple input sources and output options, complemented by an advanced control system for seamless device management.

Solution for Small Meeting Room

Provides an efficient, high-performance setup with advanced features, ensuring seamless collaboration and maximum functionality in compact spaces.

The small meeting room solution is designed to optimize space while delivering professional-grade performance. Unlike medium-sized environments, which often rely on dual screens and larger audio-visual setups, the small solution utilizes a single display screen, maximizing the powerful multiview functionality supported by the SW-640L-TX-W for dynamic content presentation in compact spaces. The 4K zoom-certified business webcam (Focus 200 Pro) meets the camera requirements for these compact setups, offering exceptional clarity and performance. This streamlined approach ensures efficiency, enhancing communication and collaboration without the complexity of larger setups.

Key Features

- Support a wide range of inputs, including USB-C and HDMI, ensuring compatibility with devices used in conference meetings and education.
- Display up to 4 video sources on a single screen, enabling efficient data comparison and seamless project collaboration.
- Allow remote monitoring and control through RS232, Relay, API, and Web UI, streamlining management and improving user experience.
- Work seamlessly with external audio systems to deliver balanced audio de-embedding, creating an immersive audio experience with professional equipment like amplifiers, speakers, and microphones.
- Enable a variety of wireless presentation methods, including Airplay, Miracast, and Dongle, to simplify participation in meetings or classes.
- Deliver power, video, audio, network, and USB data through a single USB-C cable, simplifying connections and keeping the workspace tidy.
- Ensure a stable and reliable network environment with versatile Ethernet, improving the interactive experience in hybrid meetings and educational settings.
- Provide 4K resolution for sharp, clear video, enhancing the quality of presentations.
- Utilize USB 3.0 ports for cameras, speakerphones, and keyboards, reducing cable clutter and facilitating effortless device switching, ideal for hybrid meetings and education.

What's included in the solution?

Product Model No.	Quantity
<i>You can click the product model name to visit the corresponding page.</i>	
SW-640L-TX-W	1
FOCUS 200 PRO	1
APO-DG2/APO-DG2 PRO	1
HALO-60	1

Typical Connection Diagram

Small Meetingroom Solution (Multiview)
— SW-640L-TX-W

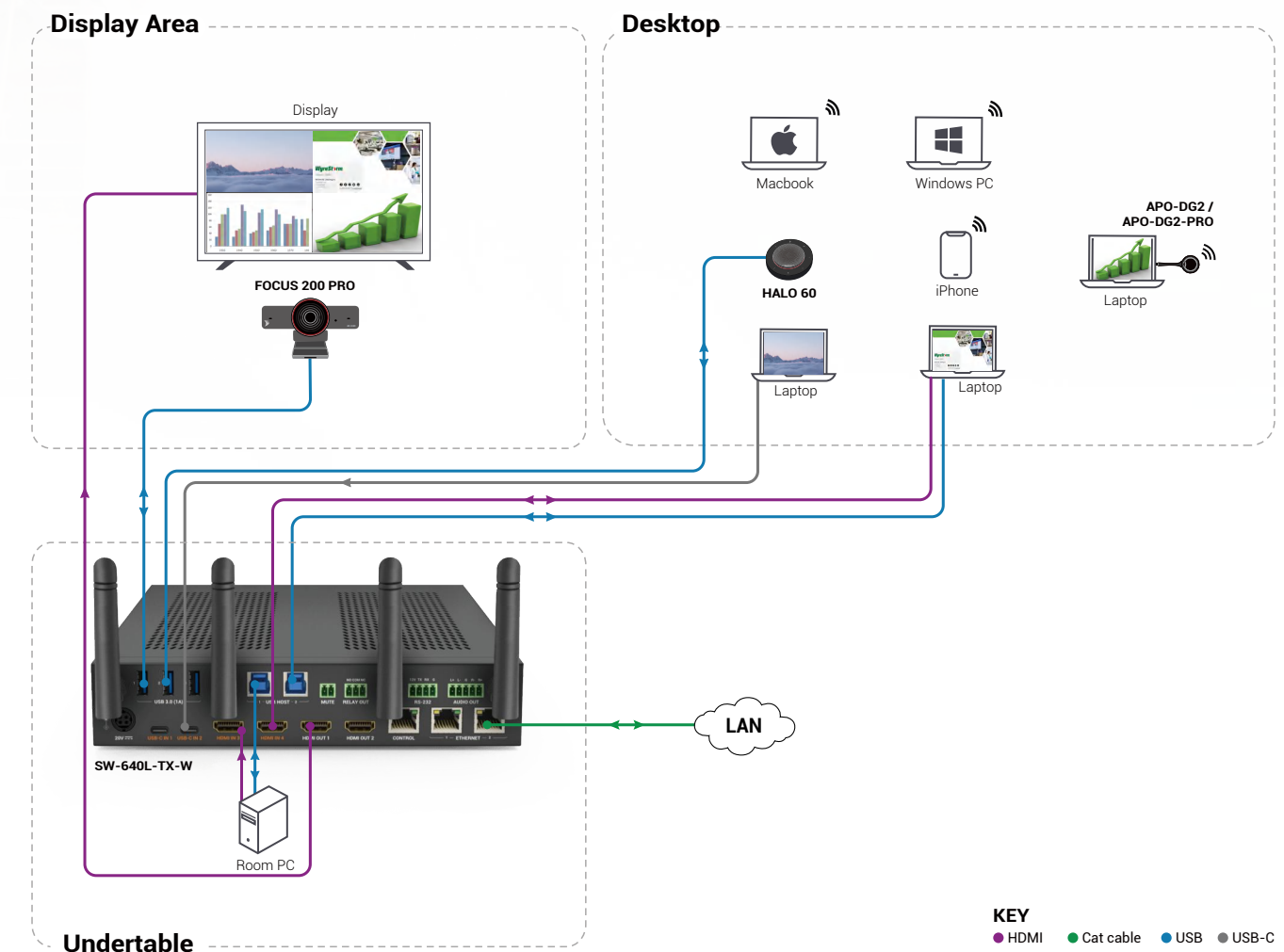

Solution for Medium Meeting Room (Wired Solution)

Achieve seamless collaboration in medium-sized meeting rooms with the MX-0402-MST matrix switch, enhancing the overall meeting experience.

The MX-0402-MST is the ideal solution for medium-sized meeting rooms, offering 4K video, dual USB-C inputs, and MST technology for seamless dual displays. It simplifies connections by transmitting video, audio, Ethernet, USB, and power through a single cable, reducing clutter and making setup easier for users. Its user-friendly design ensures smooth communication, enhancing collaboration and productivity for all participants.

Key Features

- 4K 60Hz** Deliver high-quality video performance with support for up to 4K@60Hz resolution.
- Integrate seamlessly with HALO-VX10-V2 and HALO-COM-MIC to meet hybrid and remote meeting requirements effortlessly.
- Provide comprehensive USB functionality with USB Hosts and USB Devices for versatile peripheral support.
- Offer advanced Ethernet capabilities with two Ethernet ports for bridging and isolation, plus USB Hosts for Ethernet pass-through.
- Support dual displays and MST technology for flexible video selection.
- Enable all-in-one transmission through two USB-C inputs, combining video, audio, Ethernet, USB, and power into a single cable.
- Include a built-in USB 3.0 port for easy connectivity to video bars, standard USB cameras, and speaker-phones, enhancing the meeting experience.

What's included in the solution?

Product Model No.	Quantity
MX-0402-MST <i>You can click the product model name to visit the corresponding page.</i>	1
HALO-VX10-V2	1
SYN-TOUCH10	1
HALO-COM-MIC	1

Typical Connection Diagram

Medium Meetingroom Solution (Dual Screen)
— MX-0402-MST

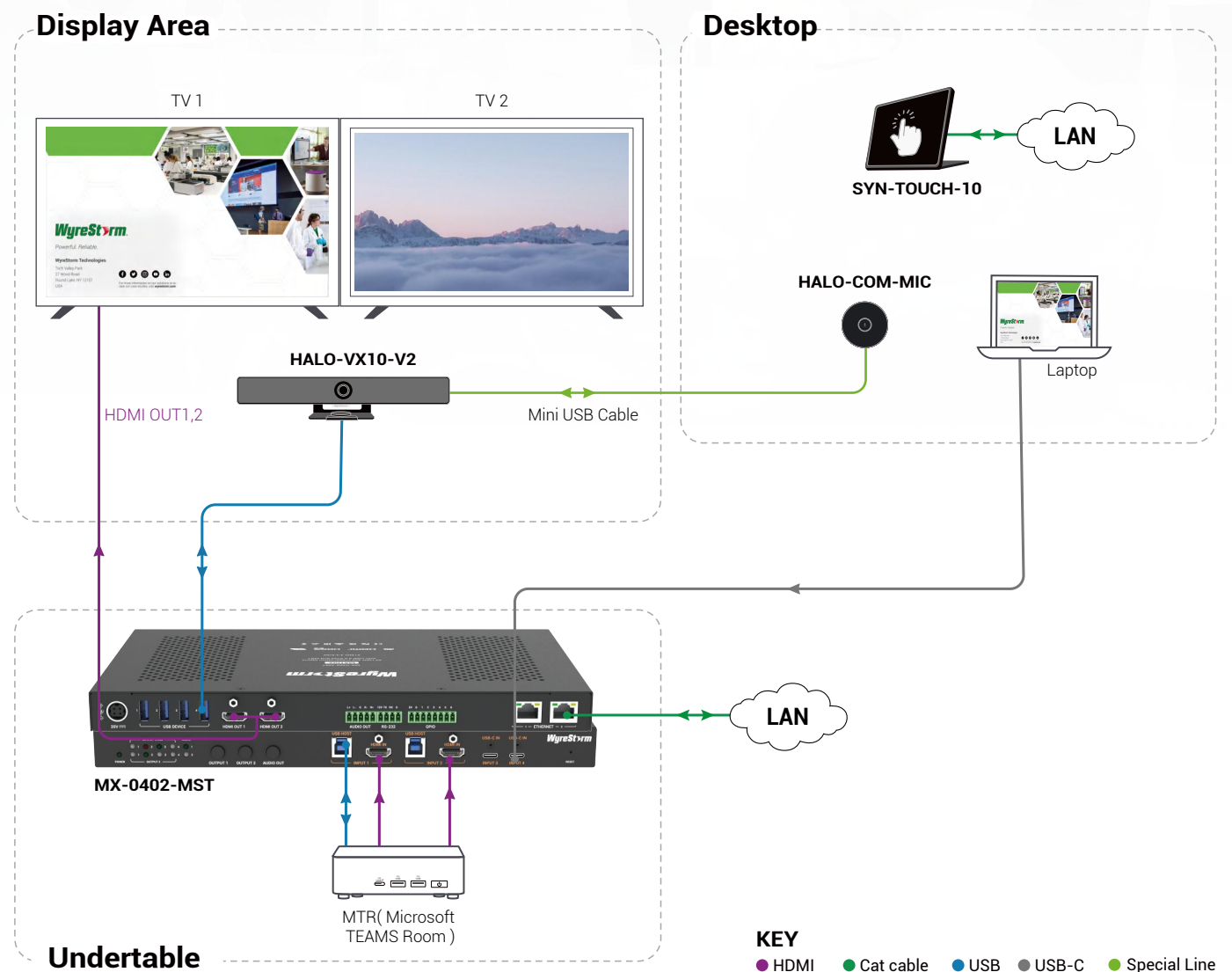

KEY
● HDMI ● Cat cable ● USB ● USB-C ● Special Line

Solution for Medium Meeting Room (Wired & Wireless Solution)

Streamline meeting setup by eliminating traditional wired connections, enabling participants to concentrate on productive discussions and collaborative decision-making.

The medium meeting room solution, featuring the SW-640L-TX-W 4K wireless presentation switcher, offers a seamless experience with wireless casting and BYOD support. Centralized control via Touch10 simplifies meeting management, while dual-screen display improves content visibility. This setup streamlines communication, enhances collaboration, and reduces technical complexities, making it perfect for medium-sized meeting rooms.

Key Features

Support a wide range of inputs, including USB-C and HDMI, ensuring compatibility with devices used in conference meetings and education.

Allow remote monitoring and control through RS232, Relay, API, and Web-UI, streamlining management and improving user experience.

Display up to 4 video sources on a single screen, enabling efficient data comparison and seamless project collaboration.

4K 60Hz Provide 4K resolution for sharp, clear video, enhancing the quality of presentations.

Deliver power, video, audio, network, and USB data through a single USB-C cable, simplifying connections and keeping the workspace tidy.

Utilize USB 3.0 ports for cameras, speakerphones, and keyboards, reducing cable clutter and facilitating effortless device switching, ideal for hybrid meetings and education.

Ensure a stable and reliable network environment with versatile Ethernet, improving the interactive experience in hybrid meetings and educational settings.

Enable a variety of wireless presentation methods, including Airplay, Miracast, and Dongle, to simplify participation in meetings or classes.

What's included in the solution?

Product Model No.	Quantity
<i>You can click the product model name to visit the corresponding page.</i>	
SW-640L-TX-W	1
HALO-VX10-V2	1
APO-DG2/APO-DG2 PRO	1
HALO-COM-MIC	1
SYN-TOUCH10	1

Typical Connection Diagram

Medium Meetingroom Solution
— SW-640L-TX-W

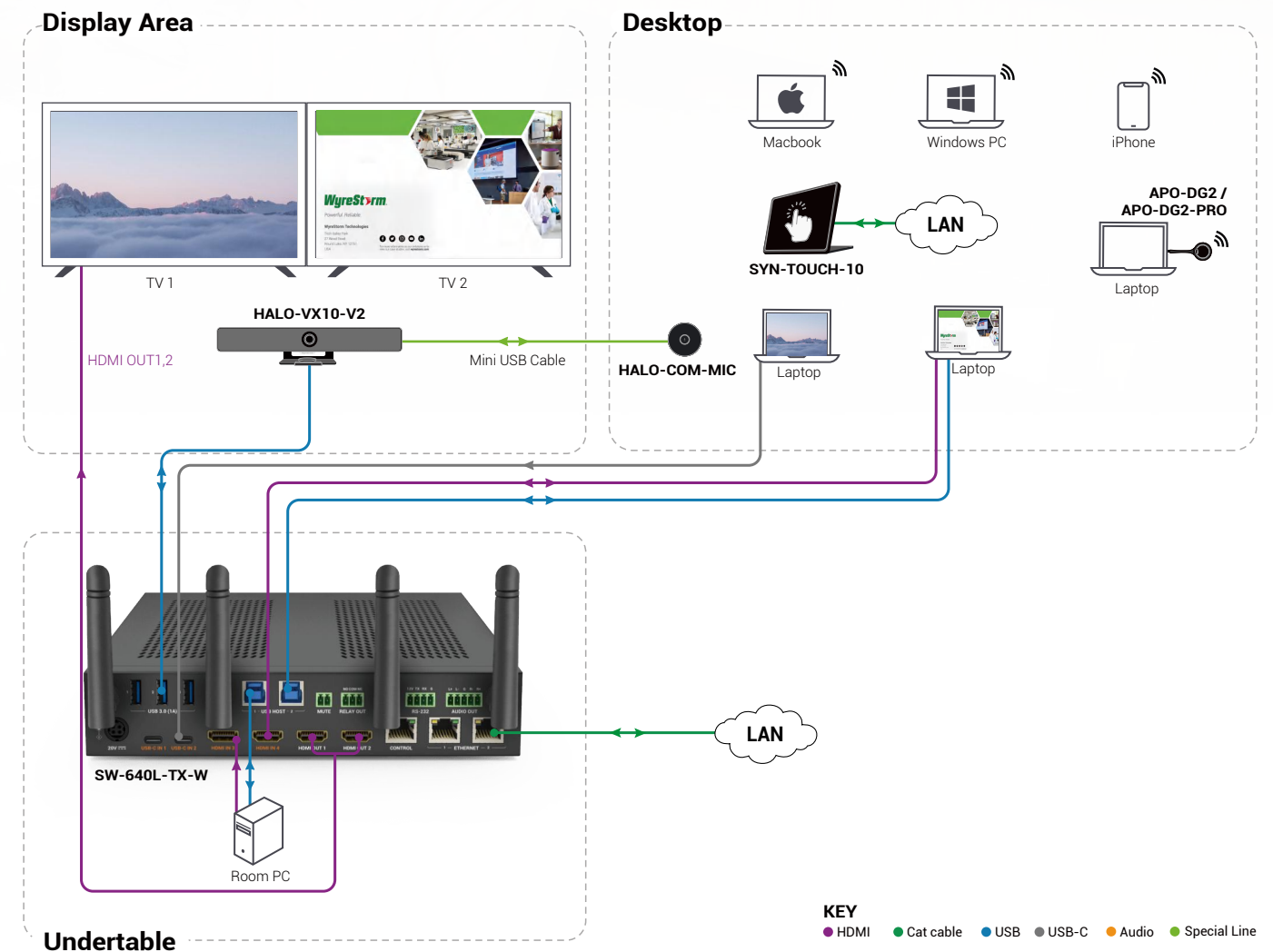

Solution for Large Meeting Room

Accommodate various participant locations around the conference table, providing multiple computer connectivity options to enhance collaboration.

This solution is designed for large meeting rooms of varying sizes, offering flexibility by simply adjusting the number of IDB-300 and NHD-510-TX. With supporting multiple computer connectivity around the conference table, it maximizes collaboration among participants. The integration of Dante audio ensures an exceptional auditory experience, creating an efficient and immersive meeting environment.

Key Features

- 4K 60Hz** Distribute 4K@60Hz content to any display with NetworkHD encoders/decoders, delivering an ultra-low latency of just 4ms for a smooth and seamless experience.
- Experience automatic source switching between HDMI and USB-C inputs on NHD-510-TX.
- Perform source switching, adjust volume, and turn on/off the screens effortlessly with the SYN-TOUCH10 touch panel controller.
- Easily configure and manage all NetworkHD devices with the NHD-CTL-PRO IP controller via intuitive web UI.
- Enhance audio distribution using Dante AV-A support for sound routed through Dante to AMP-260-DNT amplifiers then ceiling speakers.
- Enable wireless screen sharing with the SW-640L-TX-W presentation system.
- Utilize the full-featured USB-C port on NHD-510-TX for seamless transmission of video, audio, USB, Ethernet, and power delivery.

What's included in the solution?

Product Model No.	Quantity
<i>You can click the product model name to visit the corresponding page.</i>	
NHD-510-TX	6*
NHD-500-RX v2	4
SW-640L-TX-W	1
IDB-300	4*
NHD-USB-TRX	2
SYN-TOUCH10	1
NHD-CTL-PRO v2	1
COM-MIC-HUB	1
APO-SKY-MIC	4
AMP-260-DNT	2

Note: *The quantity of NHD-510-TX and IDB-300 can be arranged based on the actual size and requirements of the meeting table.

Typical Connection Diagram

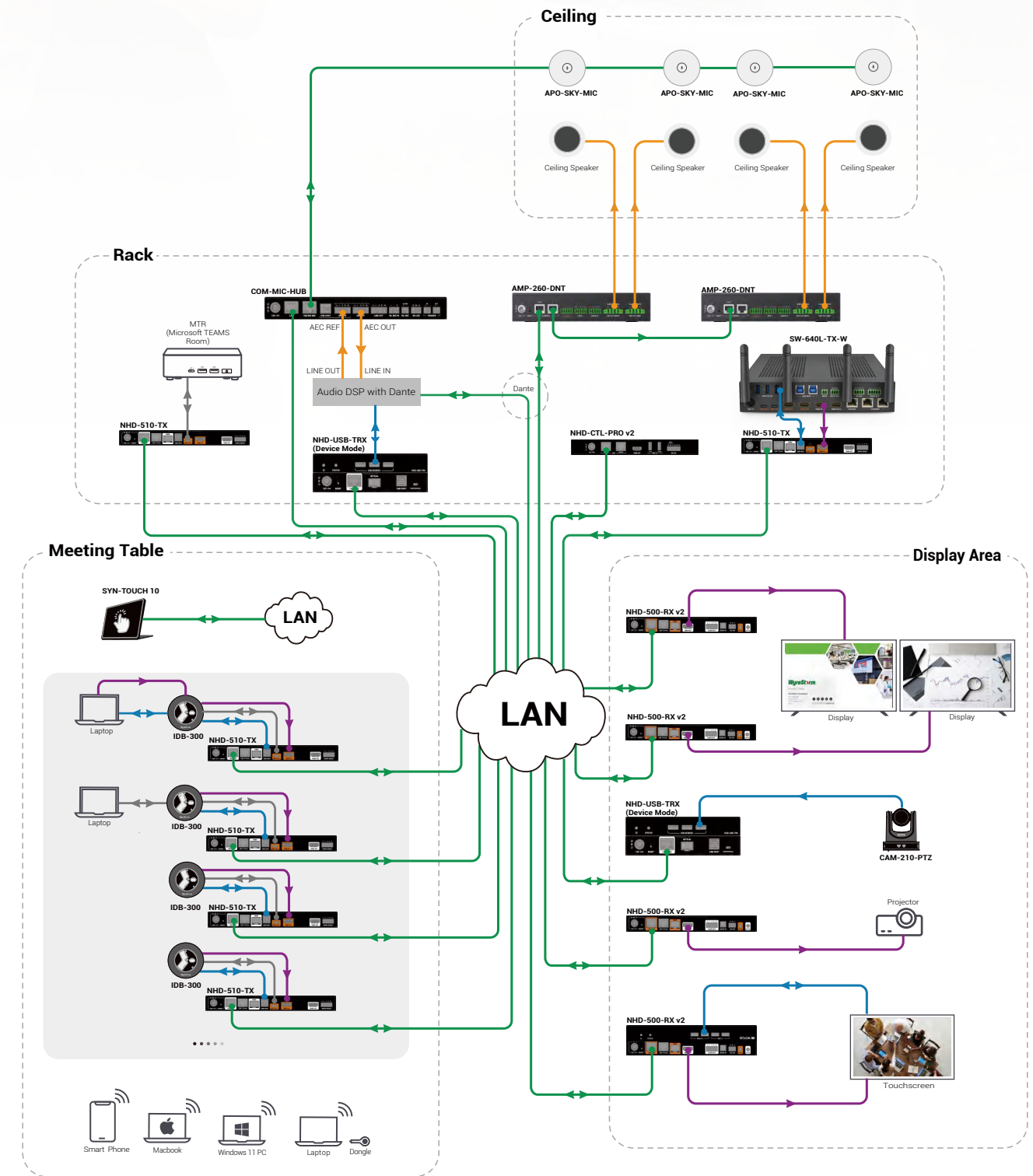

KEY
 ● HDMI ● Cat Cable ● USB ● Audio ● USB-C

Solution for Boardroom

Leverages distributed AV over IP technology to deliver high-quality audio and video with flexible scalability.

This solution supports both wired and wireless screen sharing and integrates Dante audio systems to enhance collaboration and communication efficiency in boardrooms. This solution can offer high-quality audio and video transmission, supporting both wired and wireless screen sharing methods. Equipped with Dante audio, ceiling speakers, and ceiling microphones, it provides an exceptional audio experience for all participants. The user-friendly control system enables unified audio management, making it adaptable to meeting scenarios of various sizes and facilitating efficient communication and decision-making.

Key Features

- 4K 60Hz** Distribute 4K@60Hz content to any display with NetworkHD encoders/decoders, delivering an ultralow latency of just 4ms for a smooth and seamless experience.
- Experience automatic source switching between HDMI and USB-C inputs on NHD-510-TX.
- Perform source switching, adjust volume, and turn on/off the screens effortlessly with the SYN-TOUCH10 touch panel controller.
- Supports USB 2.0 functionality to enable USB camera signal transmission back to laptops, ensuring seamless remote meeting integration.
- Enhance audio distribution and experience for all participants using Dante AV-A support for sound routed through Dante to AMP-260-DNT amplifiers then ceiling speakers.
- Enable wireless screen sharing with the SW-640L-TX-W presentation system.
- Utilize the full-featured USB-C port on NHD-510-TX for seamless transmission of video, audio, USB, Ethernet, and power delivery.
- Easily configure and manage all NetworkHD devices with the NHD-CTL-PRO IP controller via intuitive web UI

What's included in the solution?

Product Model No.	Quantity
NHD-510-TX	5
NHD-500-RX v2	4
SW-640L-TX-W	1
IDB-300	4
NHD-USB-TRX	2
SYN-TOUCH10	1
NHD-CTL-PRO v2	1
COM-MIC-HUB	1
APO-SKY-MIC	3
AMP-260-DNT	2

You can click the product model name to visit the corresponding page.

Typical Connection Diagram

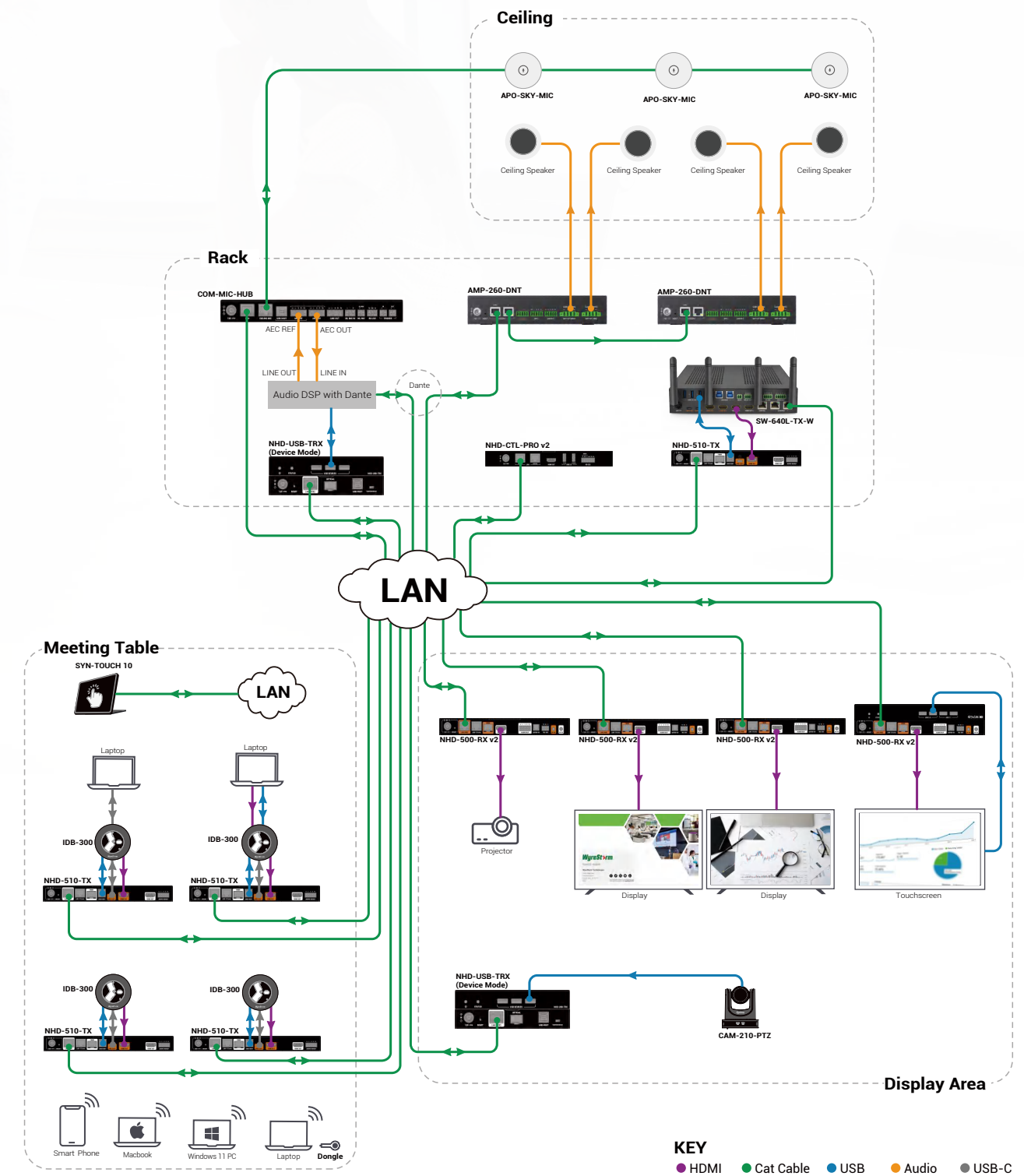

Solution for Divisible Meeting Room

Easily configure your meeting room's AV setup with our intelligent network control system, designed for flexible meeting environments that maximize resource efficiency.

This intelligent distributed AV over IP solution allows for quick switching between large and small meeting room configurations without the need to adjust network setups. Meeting rooms can be flexibly divided or combined based on specific scenarios, enhancing overall meeting convenience. The user-friendly system streamlines the process of switching between scenarios, enabling staff to easily manage devices and significantly improve interactivity and effectiveness during meetings.

Key Features

4K 60Hz Distribute 4K@60Hz content on any display with NetworkHD encoders/decoders.

Utilize the full-featured USB-C port on NHD-510-TX for seamless transmission of video, audio, USB, Ethernet, and power delivery.

Easily configure and manage all the NetworkHD devices with the NHD-CTL-PRO IP controller via the user-friendly web UI.

Control different small meeting rooms or the merged large meeting rooms without changing the device network setup.

All the staffs can easily configure the environment using the NHD-TOUCH App.

Experience automatic source switching between HDMI and USB-C inputs on NHD-510-TX.

What's included in the solution?

Product Model No.	Quantity
<i>You can click the product model name to visit the corresponding page.</i>	
NHD-510-TX	2
NHD-500-RX v2	2
IDB-300	2
NHD-USB-TRX	2
NHD-TOUCH	2
NHD-CTL-PRO v2	1

Typical Connection Diagram

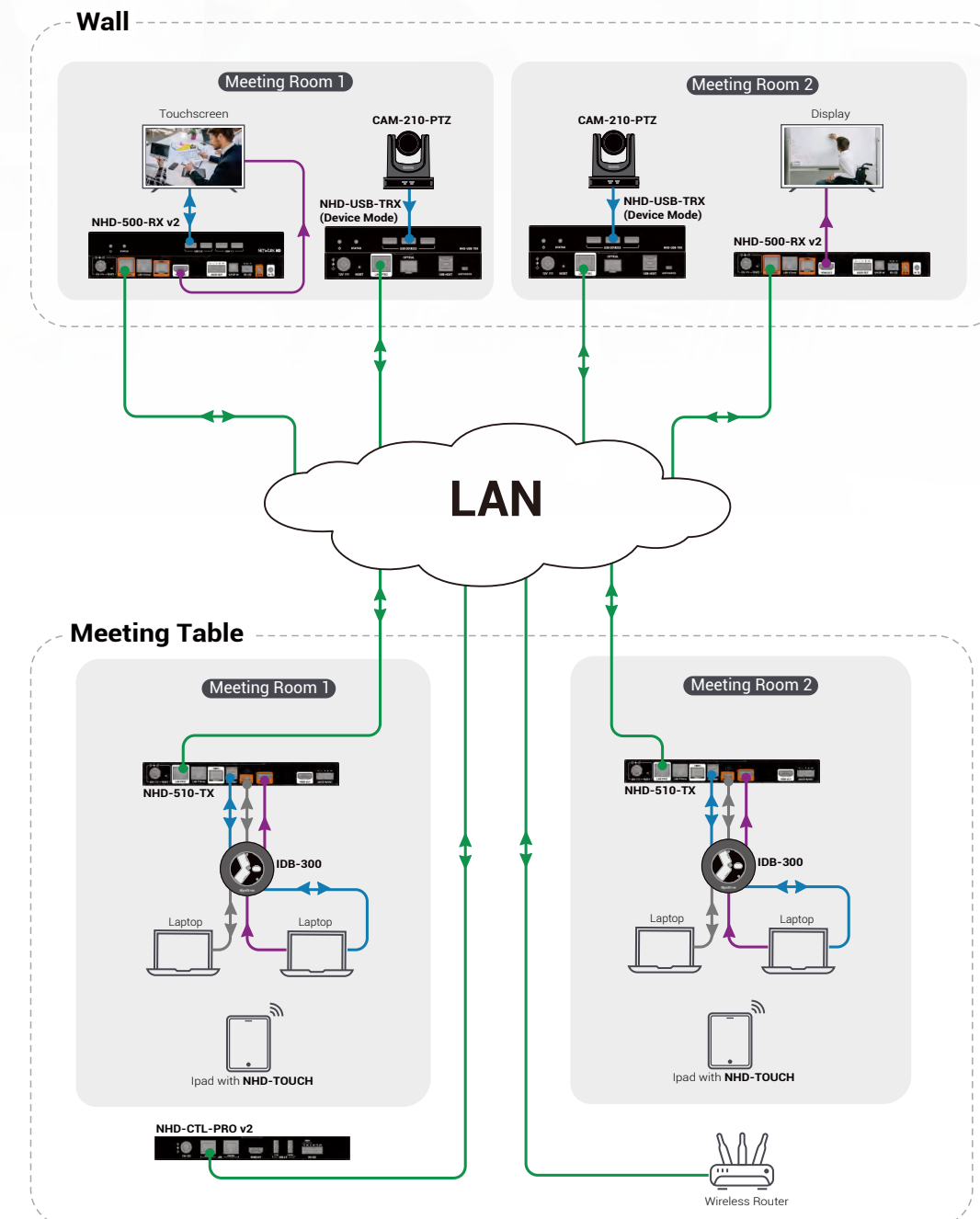

KEY

● HDMI ● Ethernet ● USB ● USB-C



Training Room Solutions

These solutions are designed to create an interactive and immersive environment, ideal for both collaborative and self-paced training sessions. They combine high-quality audio and video components with flexible configurations, making them suitable for a variety of training scenarios, from small workshops to large seminars. The selected equipment supports multiple input sources, interactive features, and an advanced control system for intuitive management, ensuring efficient and effective training sessions.

Solution for Training Room

Improve the training experience with a smooth hybrid setup, designed for a training room with around 30-50 people.

This solution is designed for corporate training rooms, ensuring excellent performance and engagement for both in-room and remote trainees through clear visuals and high-quality audio.

The MX-0804-EDC matrix switch connects multiple video sources (laptops, document cameras, PCs) to displays or projectors, providing vibrant 4K visuals. Paired with Dante audio systems and ceiling speakers, it delivers high-quality sound. Integrated USB support allows seamless connection of USB cameras and speakerphones, ensuring remote trainees have the same experience. The intuitive touch control panel simplifies managing sources, audio, and presentations.

Key Features

- 4K
60Hz
Deliver high-quality video resolution up to 4K@60Hz 4:4:4 8bit with the MX-0804-EDC presentation matrix.
- ↔
Switch fast and seamlessly between sources like laptops, PCs, and document cameras.
- 🔊
Provide professional audio performance by integrating with built-in audio DSP, amplifiers, microphone systems, and ceiling speakers.
- 🔌
Support full-featured USB-C input for video, audio, USB signal transmission, Ethernet delivery, and charging, all via a single cable.
- 👉
Connect USB devices like cameras, speakerphones, keyboards, and mice while supporting mutual conversion between USB and DSP audio.
- ☁️
Integrate effortlessly with Dante technology to ensure seamless compatibility with other Dante-enabled devices.
- 👆
Simplify system control with touch panel collaboration, making it intuitive for trainers and trainees to operate.
- 📱
Monitor and manage the system remotely with SYGMA cloud management, streamlining tasks for integrators and IT managers.
- 🔌
Enable a perfect hybrid experience with USB host functionality by supporting local USB hosts.

What's included in the solution?

Product Model No.	Quantity
MX-0804-EDC <i>You can click the product model name to visit the corresponding page.</i>	1
CAM-210-PTZ	1
COM-MIC-HUB	1
APO-SKY-MIC	3
AMP-260-DNT	1
SYN-TOUCH10	1

Typical Connection Diagram

Training Room Solution —MX-0804-EDC

- * High-quality video resolution supporting, up to 4K@60Hz 4:4:4 8bit;
- * Fast-seamless switching with no black screen;
- * Full functional USB-C input;
- * Professional audio performance by built-in audio DSP;
- * Audio transmission by Dante technique;
- * KVM supporting, connecting with camera, keyboard and mouse ... which is perfect for Hybrid teaching & meeting;
- * Flexible control by touch panel or 3rd controller;

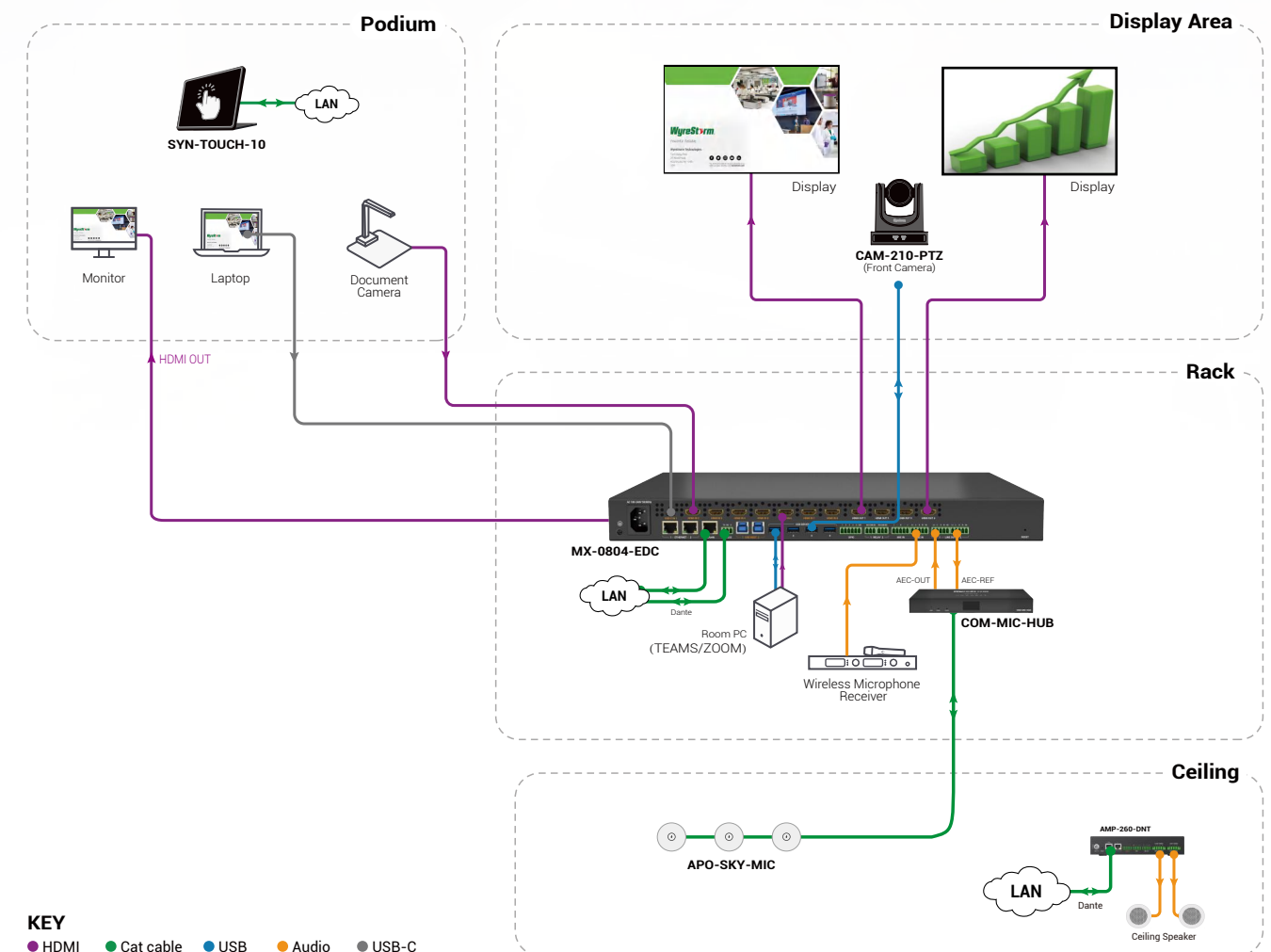

Solution for Active Training Space

Empower interactive training experiences with seamless collaboration and dynamic content sharing in corporate training scenarios.

Our active training space solution transforms corporate training rooms into dynamic hubs where each training group can easily share and interact. With flexible seating arrangements and our AV over IP solution integration, these spaces encourage collaboration and creativity. Instructors can effortlessly share content and engage with every group, utilizing tools such as interactive displays and real-time feedback systems. This fosters an interactive and efficient teaching environment, allowing for personalized guidance and support. By creating a stimulating atmosphere, this setup enhances the quality of learning and significantly boosts trainee engagement, leading to more impactful training outcomes.

Key Features

- 4K 60Hz** Distribute 4K@60Hz content to any display with NetworkHD encoders/decoders, delivering an ultralow latency of just 4ms for a smooth and seamless experience.
- Experience automatic source switching between HDMI and USB-C inputs on NHD-510-TX.
- Easily configure and manage all NetworkHD devices with the NHD-CTL-PRO IP controller via intuitive web UI.
- Connect laptops, document cameras, and room PCs for versatile content sharing.
- Streamline networking with dual Ethernet ports on NHD-510-TX, saving switch ports for each group.
- Enhance audio distribution using Dante AV-A support for sound routed through Dante to AMP-260-DNT amplifiers then ceiling speakers.
- Enable wireless screen sharing with the SW-640LTX-W presentation system.
- Utilize the full-featured USB-C port on NHD-510-TX for seamless transmission of video, audio, USB, Ethernet, and power delivery.
- Support hybrid teaching with USB 2.0 function for USB camera signal return to laptops.

What's included in the solution?

Product Model No.	Quantity
<i>You can click the product model name to visit the corresponding page.</i>	
NHD-510-TX	6*
NHD-500-RX v2	5*
NHD-USB-TRX	2
SW-640L-TX-W	1
AMP-260-DNT	2
CAM-210-PTZ	2
NHD-CTL-PRO v2	1
SYN-TOUCH10	1

Note: More NHD-510-TX and NHD-500-RX v2 units can be added based on the actual needs of the training groups

Typical Connection Diagram

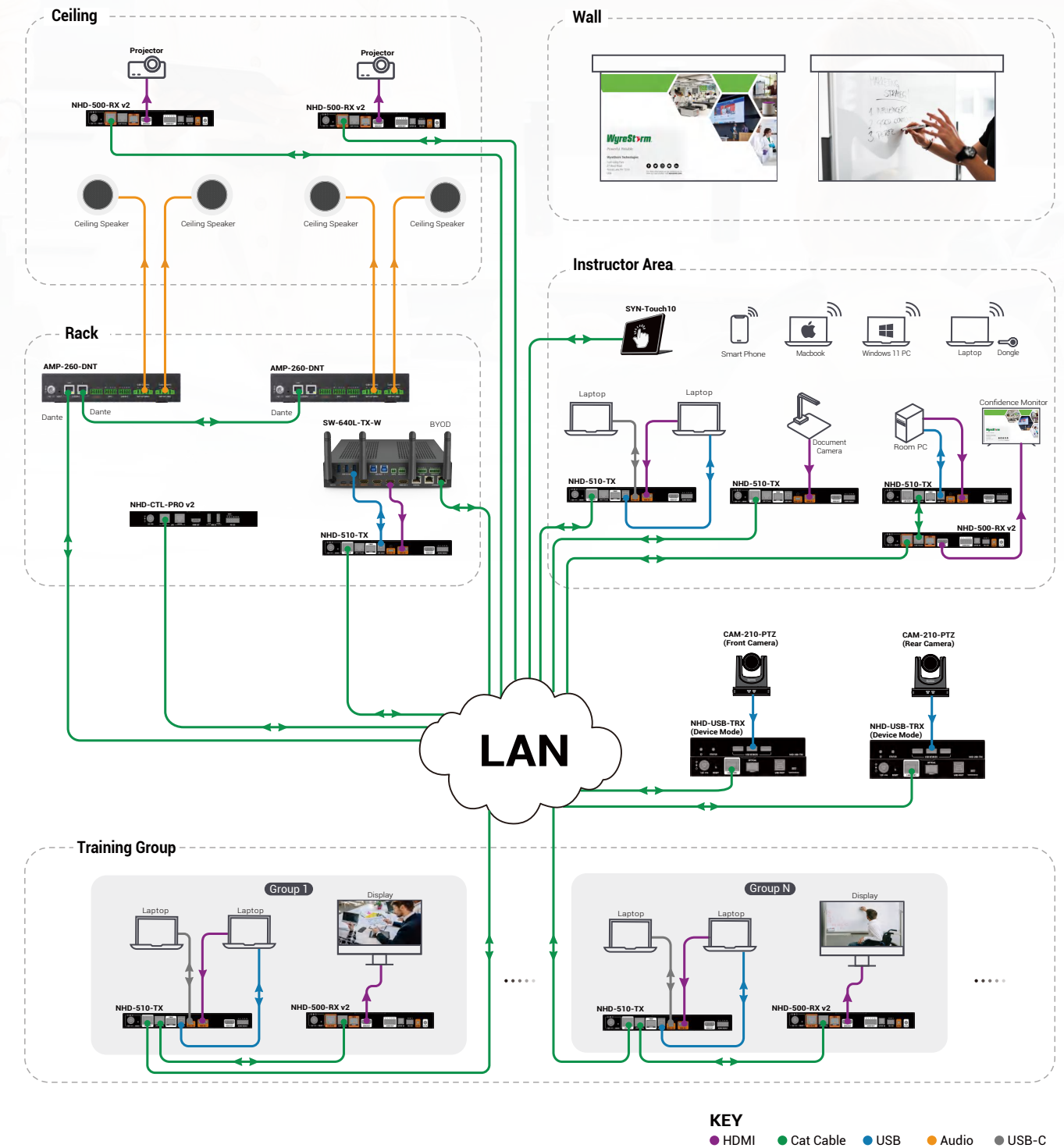







Solution for Lobby

Delivers high-quality visuals that create an engaging and dynamic atmosphere for visitors in the lobby.

This solution is designed to provide an exceptional and immersive viewing experience for visitors, transforming the lobby into a dynamic and engaging space. It supports 4K and ultra-wide resolutions, offering image scaling and independent analog audio output for high-quality, impactful visuals. With features such as image rotation and bezel adjustment, the solution ensures optimal display alignment. Flexible control options, including a user-friendly Web-UI, front panel buttons, RS232, and Telnet, enable seamless operation and efficient management of the video wall, enhancing both the visitor experience and overall operational efficiency.

Key Features

-  Create multiple splicing layouts with Quick mode (1x4, 2x2, 2x3, 3x2, 4x1, 1x4 [90°], 1x3 [60°]) and Standard mode (m x n).
-  Support cascading up to 36 screens (6x6) for large video walls.
-  Offer ultra-wide resolutions (3840x600@60Hz, 5400x1920@30Hz) for landscape-oriented video walls.
-  Adjust images with bezel correction and video rotation (0°, 90°, 180°, 270°) to enhance the viewing experience.
-  Deliver high-resolution video up to 4K@60Hz, ideal for displaying detailed information on large screens.
-  Manage the video wall efficiently through a user-friendly Web UI.

What's included in the solution?

Product Model No.	Quantity
<p><i>You can click the product model name to visit the corresponding page.</i></p> <p>SW-0206-VW </p>	1

Typical Connection Diagram

Videowall processor perfect for create small or medium videowall, supporting — SW-0206-VW

- * Multiple splicing video-wall:
 - Quick mode: 1x4, 2x2, 2x3, 3x2, 4x1, 1x4[90°], 1x3[60°]
 - Standard mode: m x n
- * Cascading feature supports, up to 36 screens (6x6)
- * Videowall rotation: 0°, 90°, 180°, 270°
- * High-quality video solution up to 4K@60Hz 4:4:4 8bit
- * Ultra-wide solution: 3840x600@60Hz, 5400x1920@30Hz
- * OSD supports for each HDMI outputs
- * User-friendly Web-UI to operate

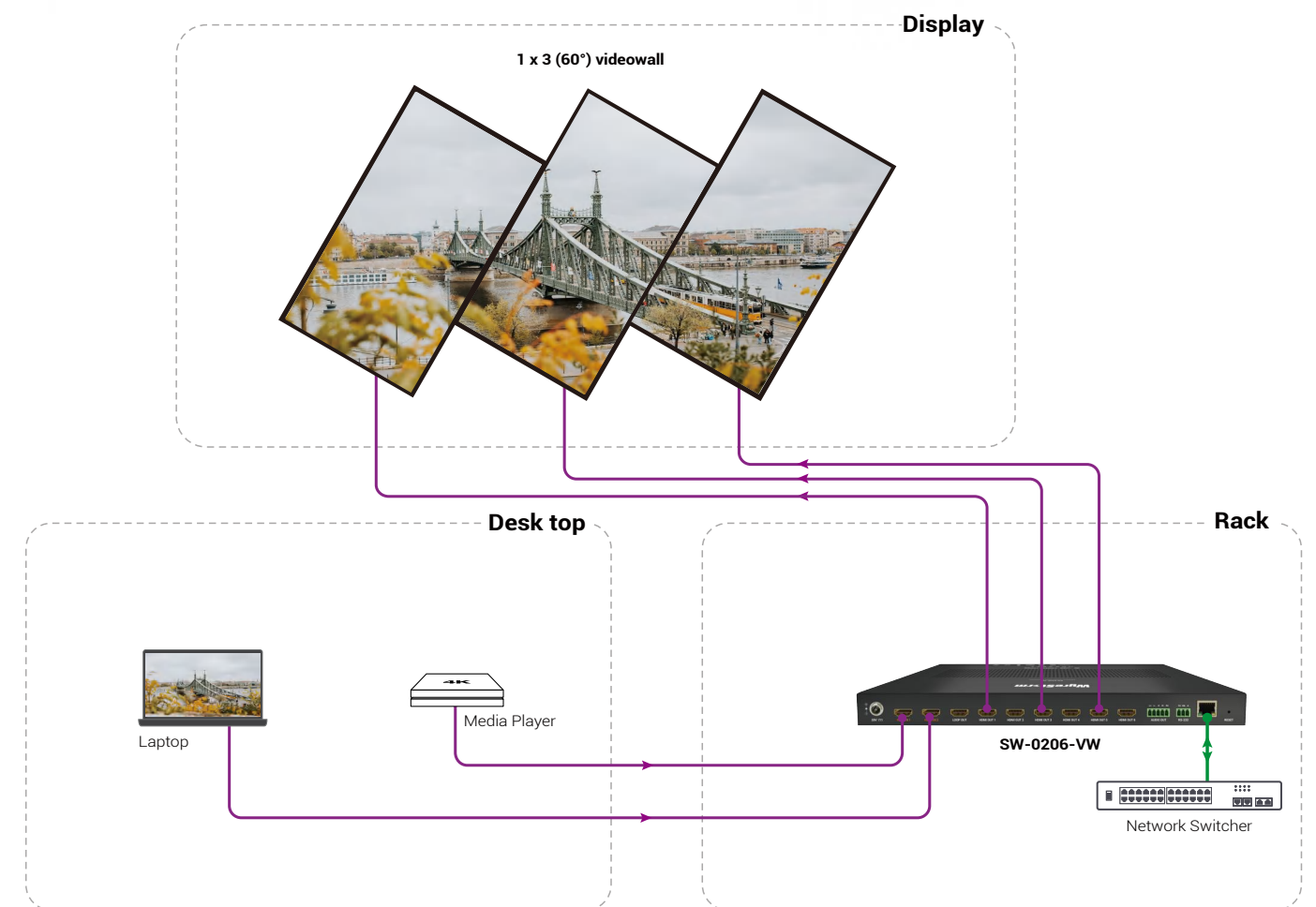

KEY
 ● HDMI ● Cat cable ● USB ● Audio ● USB-C

Solution for Exhibition Hall

Enhance the convenience and usability of your corporate exhibition hall with this distributed AV over IP solution.

This solution enables centralized content management in a dedicated equipment room, allowing seamless switching between display sources. Featuring advanced video walls and multiview capabilities, it offers various presentation styles to impress clients. With vibrant visuals and flexible layouts, you can create captivating displays that highlight products and services. The user-friendly control system allows easy content switching during presentations, ensuring a dynamic, engaging experience and better showcasing of your offerings.

Key Features

- Paired with the NHD-150-RX, it supports multiview output and can connect to LED large screens to display more information.
 Supports video wall functionality to display detailed information on large screens, ensuring clear visibility for everyone. It supports up to a 16x16 video wall.
- Connect computers, DVD players, cameras, and satellite boxes for versatile content sharing.
 Distribute 4K@30Hz content on any display using NetworkHD encoders/decoders.
- Easily switch videos by downloading the NetworkHD Touch App on a tablet and pairing it with the NHD-CTL-PRO.

What's included in the solution?

Product Model No.	Quantity
<i>You can click the product model name to visit the corresponding page.</i>	
NHD-120-TX	4
NHD-120-RX	18*
NHD-150-RX	1
NHD-CTL-PRO v2	1
NHD-TOUCH	1

*Note: More NHD-120-RX units can be added based on the actual needs of the displays in the exhibition area.

Typical Connection Diagram

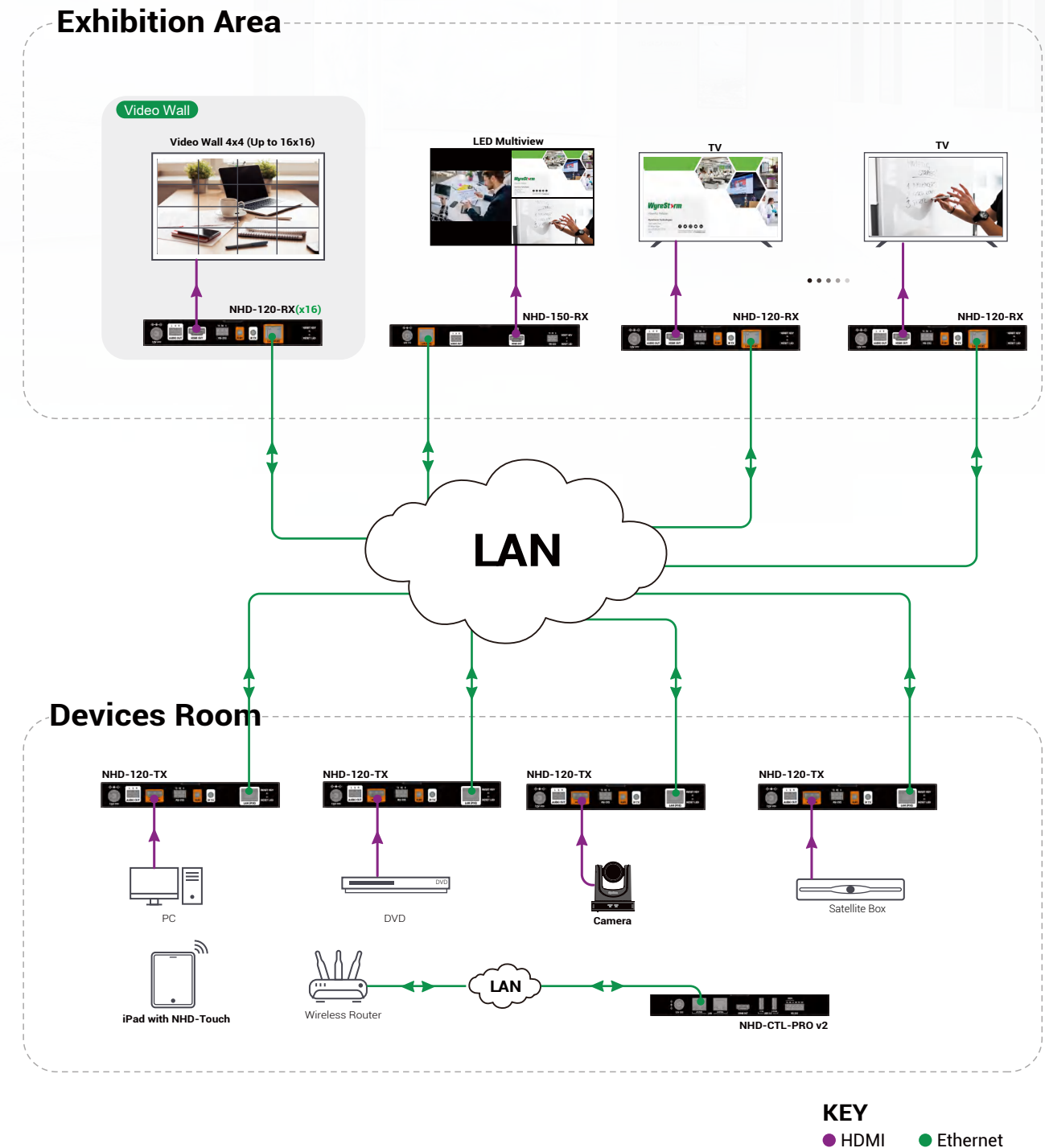

Solution for Executive Room

Integrates a wireless presentation switcher and KVM docking station to create a streamlined workspace that boosts productivity and simplifies meeting management.

This executive room solution integrates advanced technologies to enhance productivity and streamline operations. Featuring a 4K wireless presentation switcher, it enables seamless wireless casting, BYOD (Bring Your Own Device) support, and single-screen Multiview functionality for dynamic presentations. The addition of the IDB-300 desktop insert simplifies device access directly from the meeting table, while the KVM Docking Station optimizes workspace efficiency, allowing executives to seamlessly manage both meetings and personal work from their seat. This combination ensures a more efficient, flexible, and professional environment.

Key Features

- Support diverse input options, including USB-C and HDMI, ensuring compatibility with devices used in conference meetings and education.
- Display up to four video sources simultaneously on a single screen, enabling efficient data comparison and streamlined project collaboration.
- Enable remote monitoring and control with RS232, Relay, API, and Web-UI, streamlining management and improving user experience.
- Provide advanced Ethernet capabilities for a reliable and stable network environment, enhancing interactivity in hybrid meetings and education.
- Enhance productivity with dual-screen management, fast switching, and comprehensive peripheral connectivity, ideal for professional workspaces.
- Deliver power, video, audio, network, and USB transmission through a single USB-C cable, simplifying connections and keeping workspaces organized.
- Facilitate seamless device switching with USB 3.0 ports for cameras, speakerphones, and keyboards, eliminating cable clutter and enhancing hybrid meeting and education experiences.
- Ensure sharp, clear 4K video resolution, delivering high-quality visuals for immersive presentations and engaging content.
- Support wireless casting methods, including Airplay, Miracast, and Dongle, simplifying content sharing in meetings or classes.
- Simplify AV control and connectivity with intuitive access to essential meeting functions, ensuring a seamless conference experience.

What's included in the solution?

Product Model No.	Quantity
SW-640L-TX-W <i>You can click the product model name to visit the corresponding page.</i>	1
HALO-VX10-V2	1
APO-DG2/APO-DG2 PRO	2
HALO-COM-MIC	1
IDB-300	1

Typical Connection Diagram

Executive Room Solution (Multiview & KVM Docking Station)
— SW-640L-TX-W

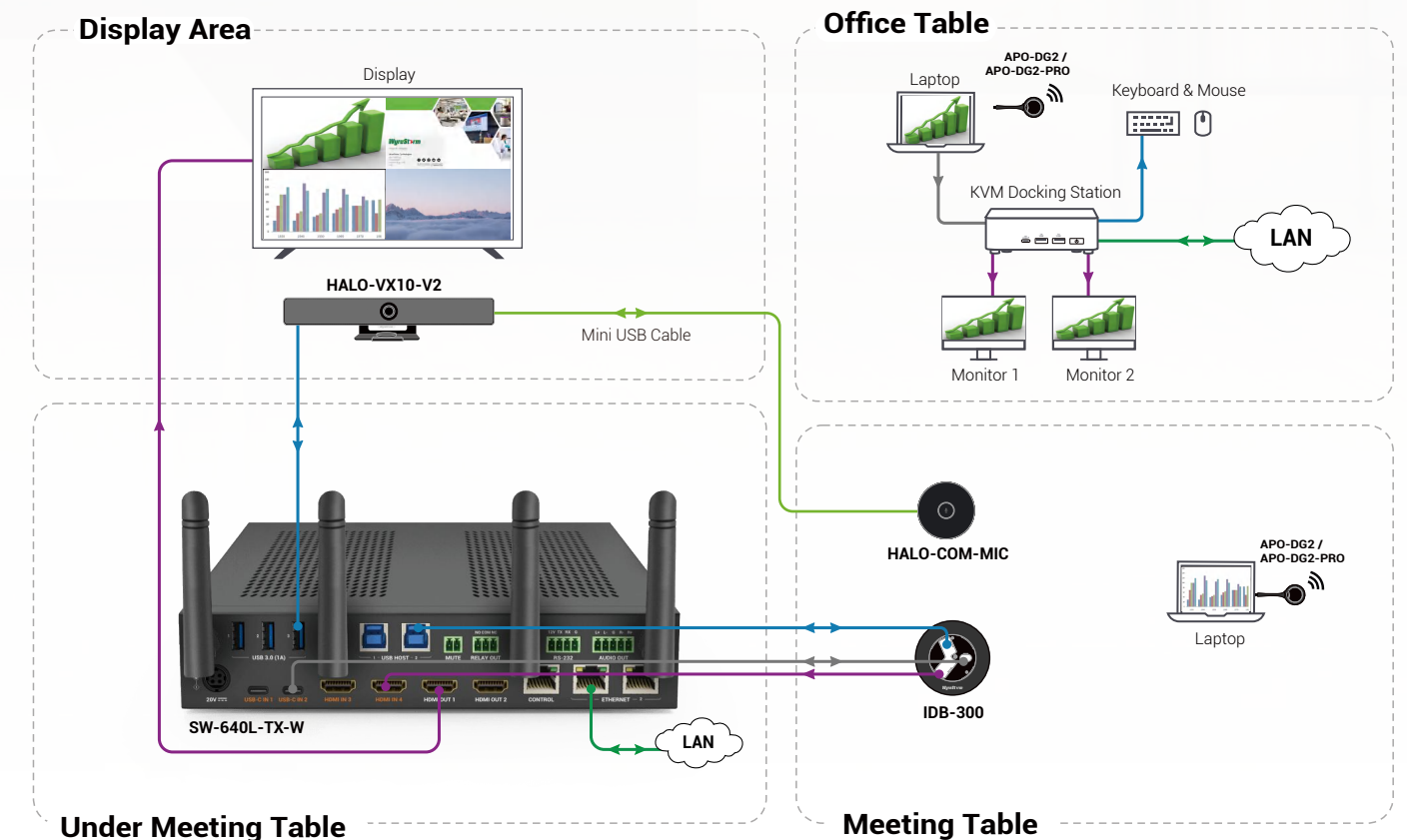

KEY
● HDMI ● Cat Cable ● USB ● USB-C ● Special Line

A photograph of five business professionals in a modern office setting. A man in a grey suit stands and speaks to a group of four seated colleagues (two women and two men) who are listening attentively. The scene is brightly lit by large windows in the background.

Thank you for your time.

WORLDWIDE Toll free: +1 (844)-280-WYRE (9973)
North America: +1 518-289-1294
International: +44 (0) 1793 676 683
Email: support@wyrestorm.com