

# SPL6 UNIVERSAL MOUNTING BRACKET

Installation guide for James Loudspeakers SPL6 SoundBar universal mounting bracket.



**Part A** (Pre-Assembled)  
(2) VESA rails, (2) Bracket rails,  
(2) Long swivel joints (part B)

## BRACKETS SUPPLIED HARDWARE

Part #	QTY	Screws
#1	28	VESA Spacers (1.25" x 0.125")
#2	4	M8-50mm Pan Head Philips Screws
	4	M8-45mm Pan Head Philips screws
	4	M8-35mm Pan Head Philips screws
#3	4	M6-50mm Pan Head Philips Screws
	4	M6-45mm Pan Head Philips screws
	4	M6-35mm Pan Head Philips screws
#4	4	UNC 1/4"-20" Pan Head Philips Screws
	4	Sealing Washers (0.625" x 0.275")
	2	UNC 10-24 Flat Head



**1** Place the display on a padded flat surface.

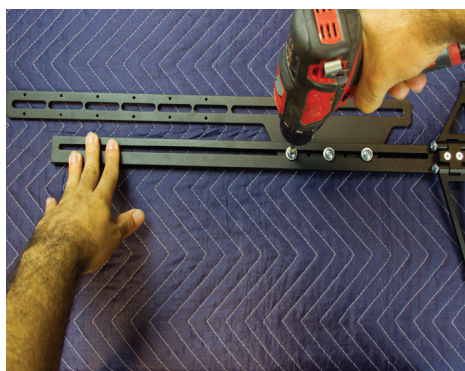

**2** Loosen screws on bracket and pre-assembled swivel joints, so that they can slide/pivot with little resistance. If extra support is desired on the sliding portion of the bracket, then use the additional screws and washers provided.



**3** Before mounting the bracket to the rear of the display, first insert the bracket into the channel located on the rear of the SoundBar.



**4** After the bracket has been inserted into the channel of the SoundBar, slide the bracket left to right to align them to the VESA pattern on the rear of the display.



**5** Spacers have been provided to elevate the SPL bracket high enough to clear any protrusions on the display that may interfere with the bracket mounting process. We recommend using the minimal amount of spacers required to clear any protrusion.



Non James TV bracket shown for illustration

**6** Determine the screw size, M6 or M8, required to mount your wall bracket to the display. Select either the M6 or M8 hardware bag. 3 lengths are provided, 35mm, 45mm, and 50mm. Select the correct length to match the spacer quantity (height) and then loosely mount the brackets to the rear of the display.

# SPL6 UNIVERSAL MOUNTING BRACKET

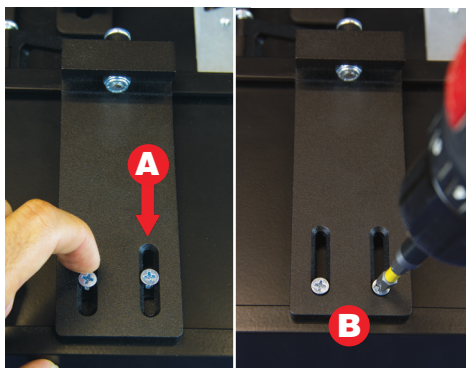

- 7** **A** - Slide the adjustable portion of the holding tab into the bottom slot of the SoundBar.  
**B** - Tighten the two screws on each of the holding plates

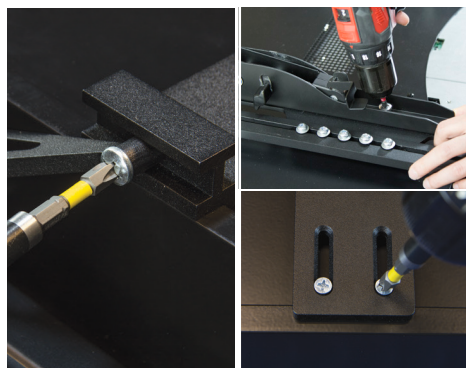

- 8** Make all final adjustments to swivel joints and bracket tabs, make sure to avoid stressed positions/alignments. Lastly, tighten all screws on joints & tabs while applying constant pressure on the SoundBar so that it's snug against the display while tightening fasteners.

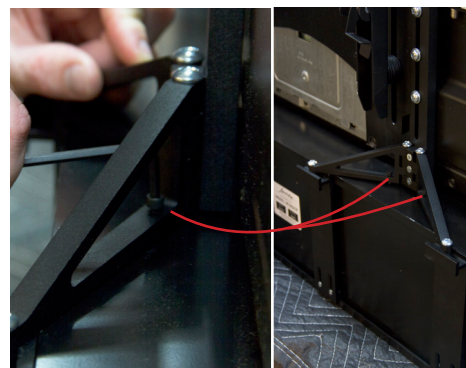

- 9** If desired, tightening the set screws located in the bracket's trusses will make micro adjustment's to the SoundBar's tilt angle.



- 10** Connect wires to terminals, ensuring correct polarity, before mounting to wall.



- 11** Follow the manufacturer's instruction for the wall mount installation. (Will require 2 or more people).