

AP-PM-BARCO

ADAPTER FOR BARCO BALDER, BRAGI, LOKI & MEDEA

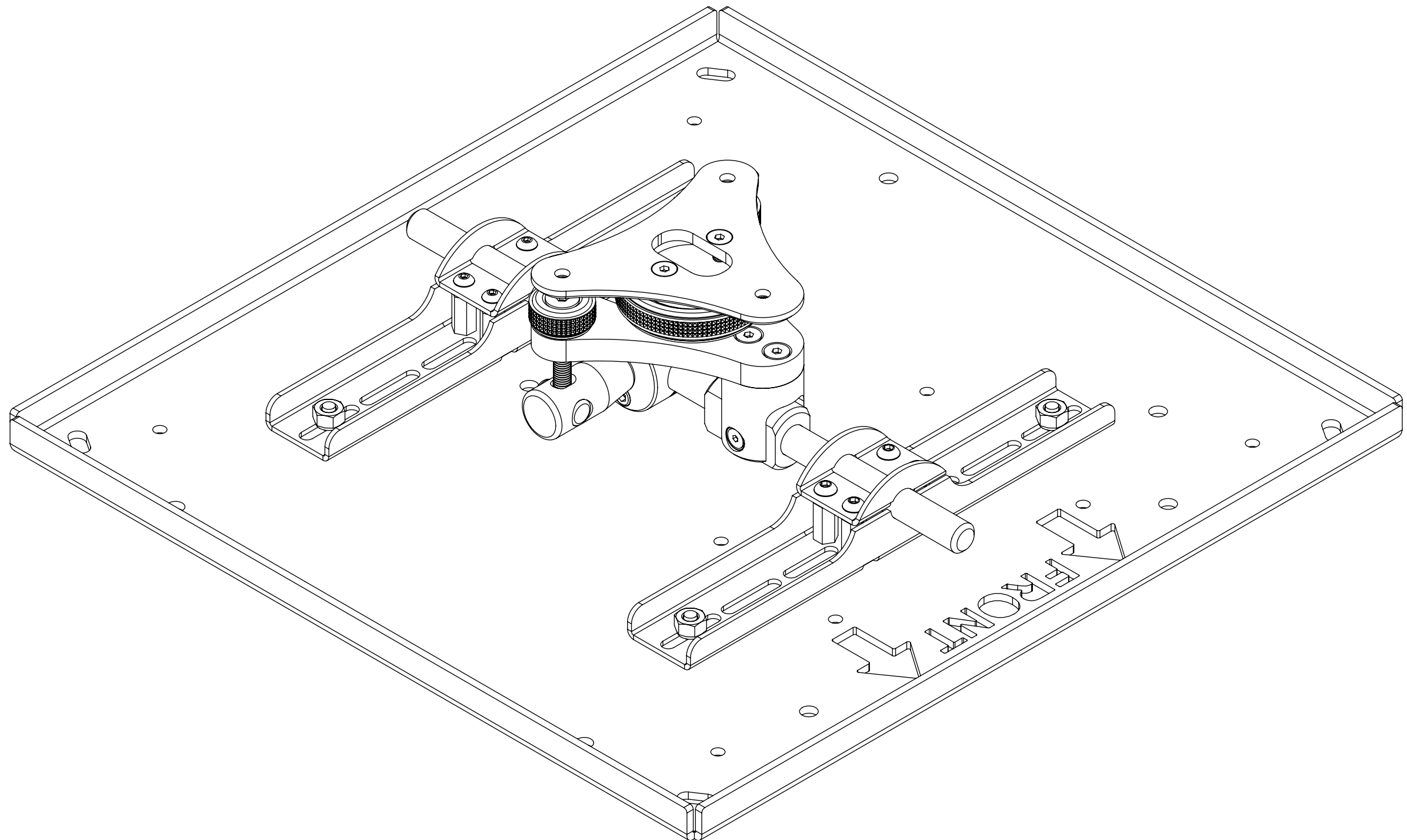

future automation



AP-PM-BARCO

ADAPTER FOR BARCO BALDER, BRAGI, LOKI & MEDEA



future automation

SPECIFICATION	MEASUREMENTS
Product Dimensions (Including PM-UNI)	440 x 455 x 101mm (17.3 x 17.9 x 3.9")
Maximum Weight Capacity	55kg (121lbs)
Depth From Ceiling (Including PM-UNI)	101mm (3.9")
Product Weight (Including PM-UNI)	5.5Kg (12.1lb)
Packaging Dimensions	500 x 470 x 40mm (19.7 x 18.5 x 1.6")
Shipping Weight	3kg (6.6lbs)
Maximum Rotation	360°
Movement Type	Manual
Adjustments	Pitch, Roll and Yaw are adjustable
Mounting Options	Flush Surface, Pole, Telescopic Pole, NPT Pipe
Product Options / Features	Custom RAL paint finishes
Package Contents	Adapter Plate
Marine Suitable	Yes (Indoor)

AP-PM-BARCO

ADAPTER FOR BARCO BALDER, BRAGI, LOKI & MEDEA



future automation

GENERAL DIMENSIONS

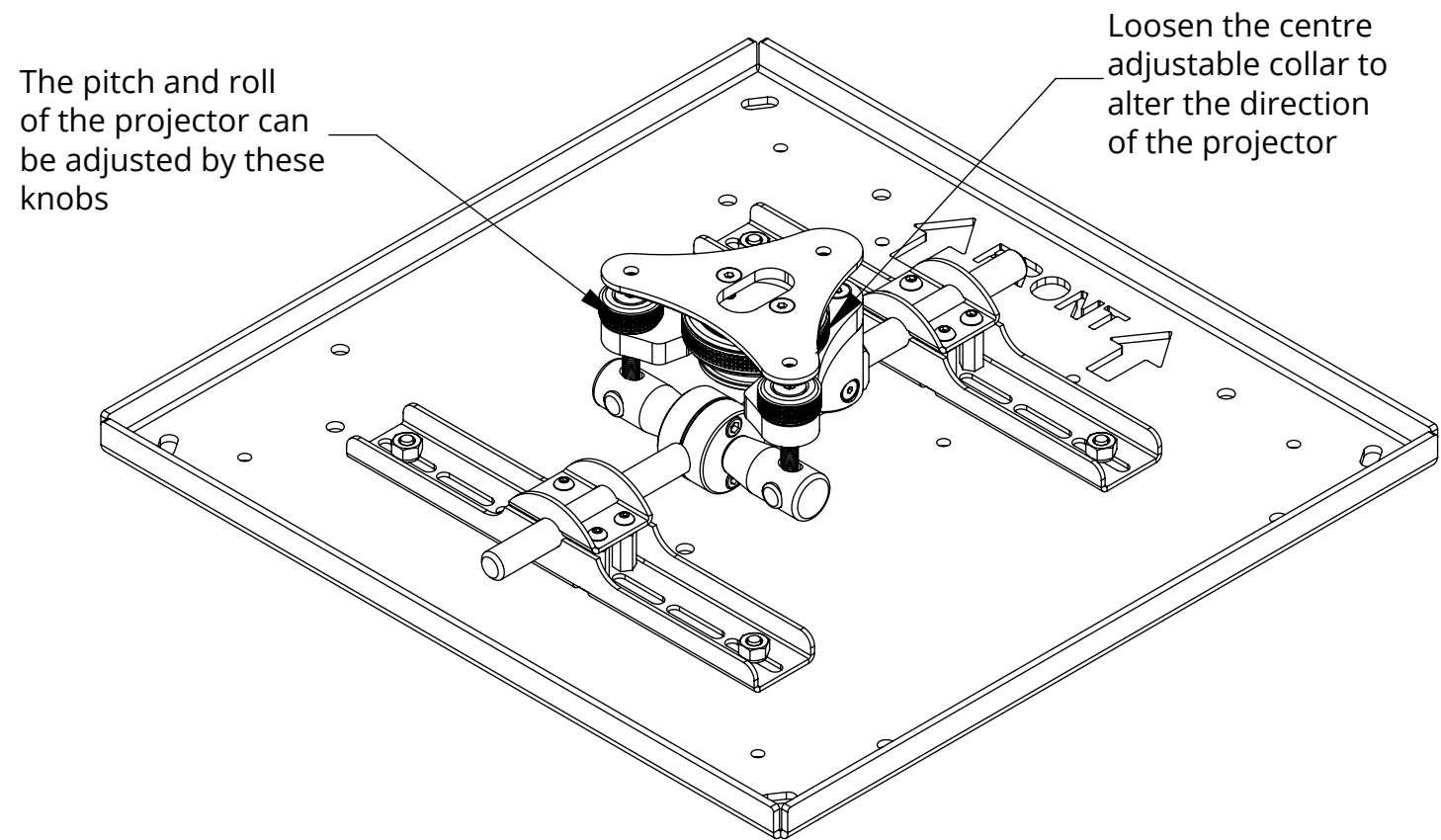

MOUNTING HOLES:

BA = BALDER
BR = BRAGI
L = LOKI
M = MEDEA

