

LSM-TU-HF 5

LIFT SYSTEM TELESCOPIC WITH HEAVY FLAP

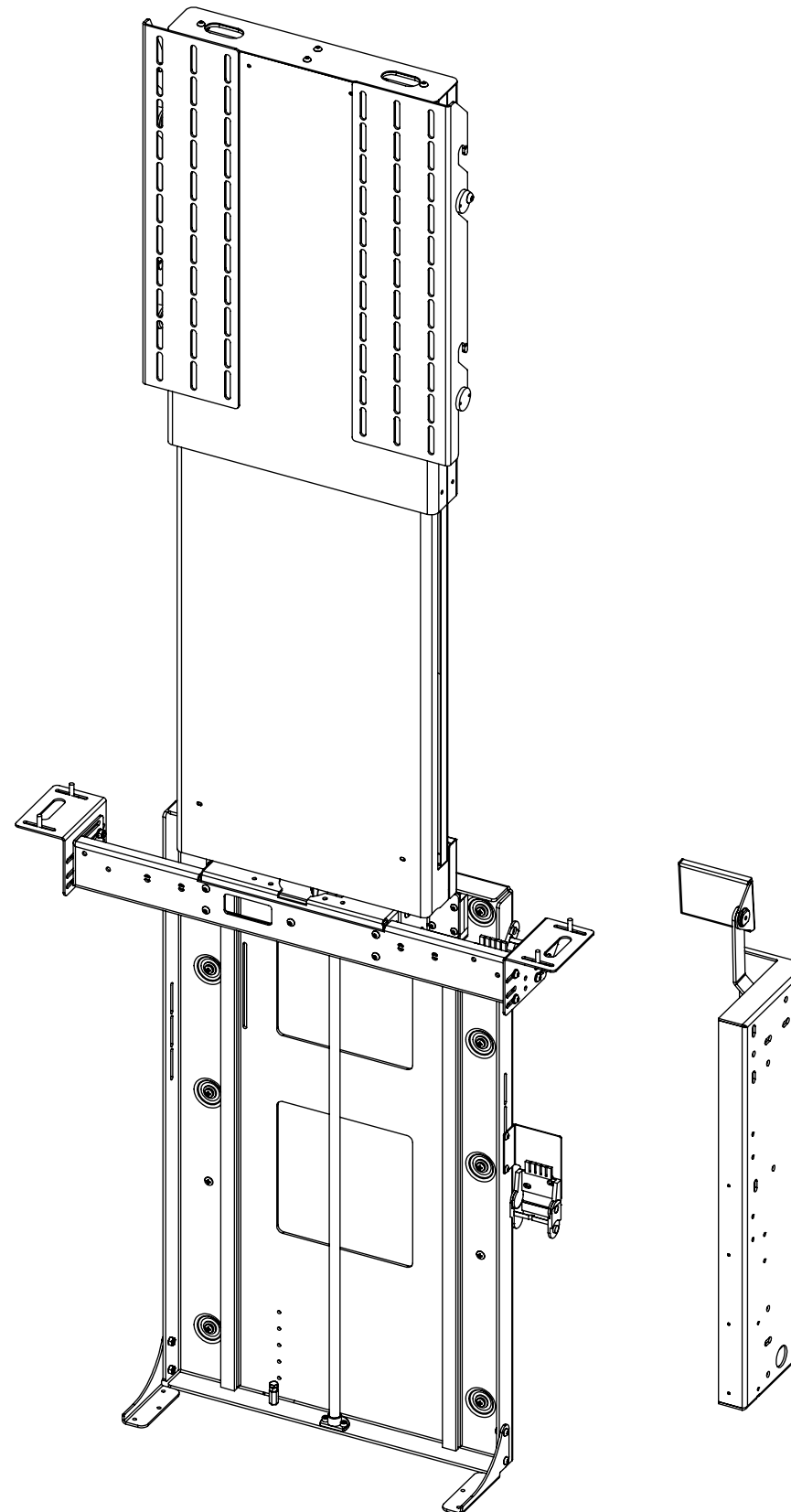

future automation



LSM-TU-HF 5

LIFT SYSTEM TELESCOPIC WITH HEAVY FLAP



future automation

SPECIFICATION	MEASUREMENTS
Maximum Screen Size	740mm (29 1/8") Height, 60mm (2 3/8") Depth
Maximum Weight Capacity	30Kg (66lb)
Speed	40mm/s
Maximum Lift Distance	1284mm (50 9/16") from top of screen to cabinet top
Internal Cabinet Height	880mm (34 5/8")
Decibel Rating	52dB
Packaging Dimensions	TBC
Shipping Weight	TBC
Movement Type	Motorised
Power Supply Required	110V - 240V AC
Power Consumption	250 - 500W
Power Consumption Standby	3W
Mounting Patterns Supported	VESA 400, 300, 200 W x 400, 300, 200 H
Control Options	IR Remote, RS232, Contact Closure
Product Options / Features	Specific B&O and Loewe mounts / adapters, Custom RAL paint finishes
Package Contents	Mechanism, IR remote control
Marine Suitable	No

LSM-TU-HF 5

LIFT SYSTEM TELESCOPIC WITH HEAVY FLAP

CABLE ROUTING

Screen Cables enter the top of the Telescopic Unit and are fed down through the Cable Track within. This can be accessed by removing the two front covers of the Telescopic Unit. The cables then pass through the LSM Beam and into the LSM Cable Track. Cables must be routed carefully to prevent any interference with the LSM beam as it operates.

Screen and Mechanism cables should be routed to a control box outside of the cabinet via an opening in the back of the cabinet or a conduit leading to the bottom.

- SCREEN CABLES
- MECHANISM CABLES
- POWER CABLE

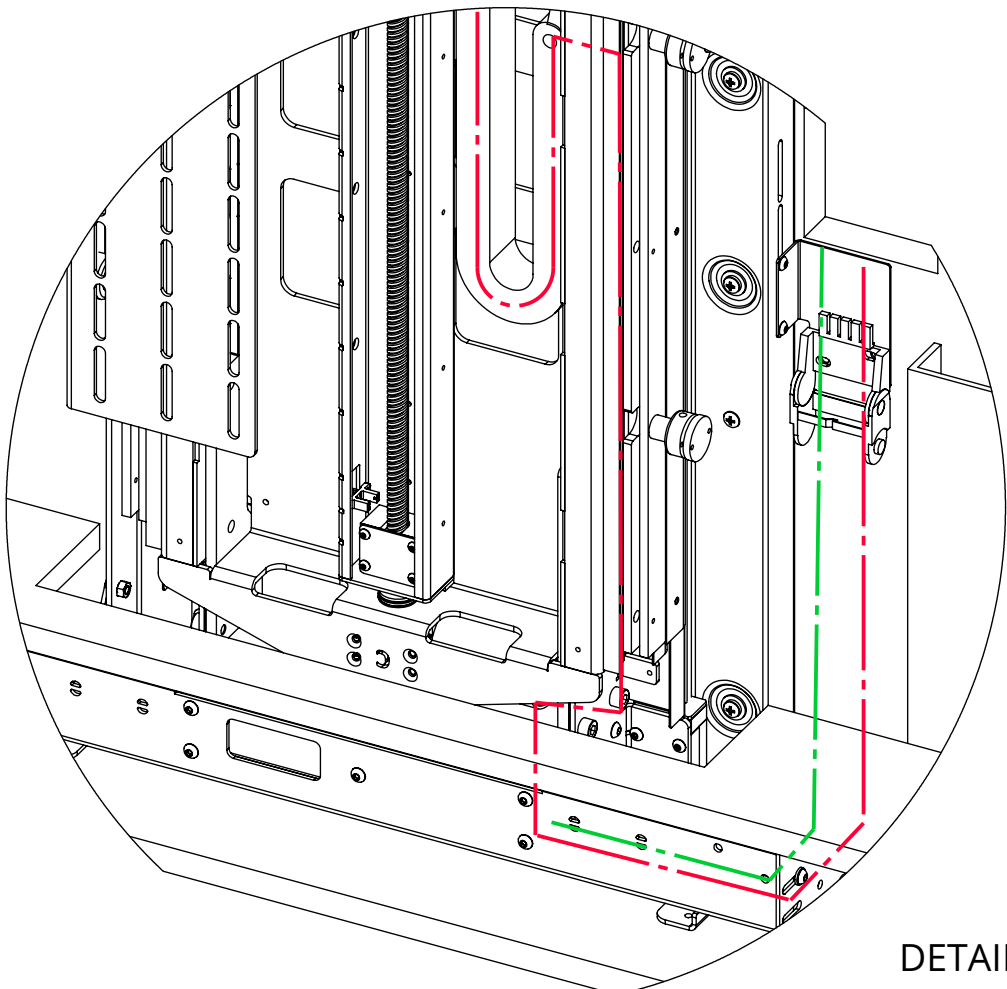

DETAIL A

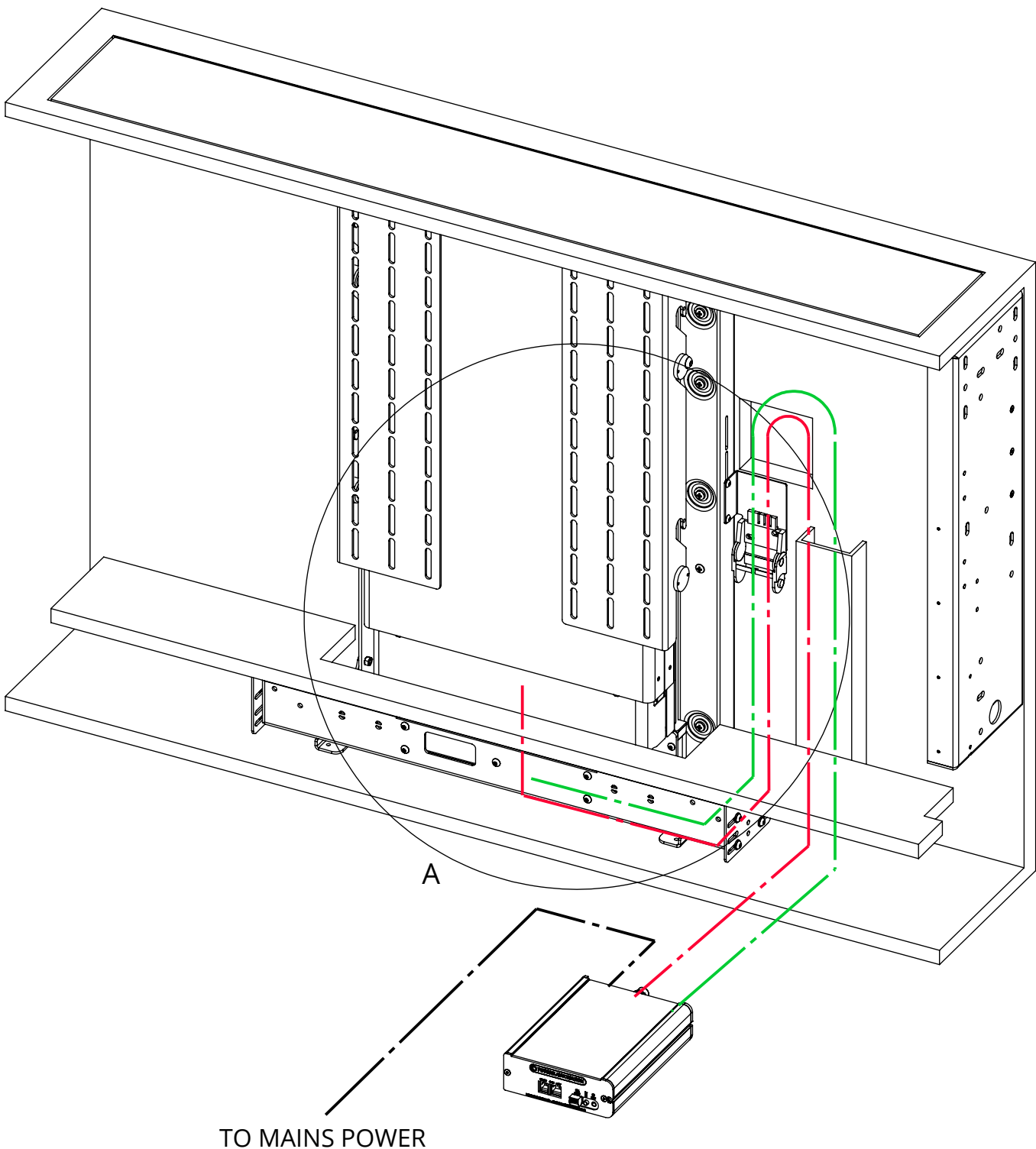

LSM-TU-HF 5

LIFT SYSTEM TELESCOPIC WITH HEAVY FLAP



future automation

MECHANISM UP - OUT OF CABINET

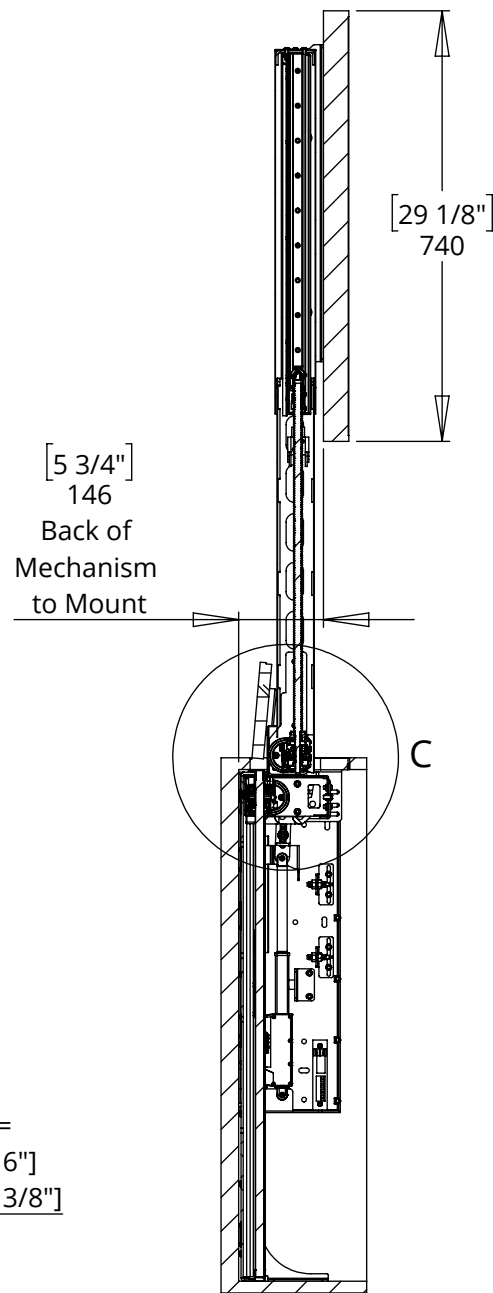
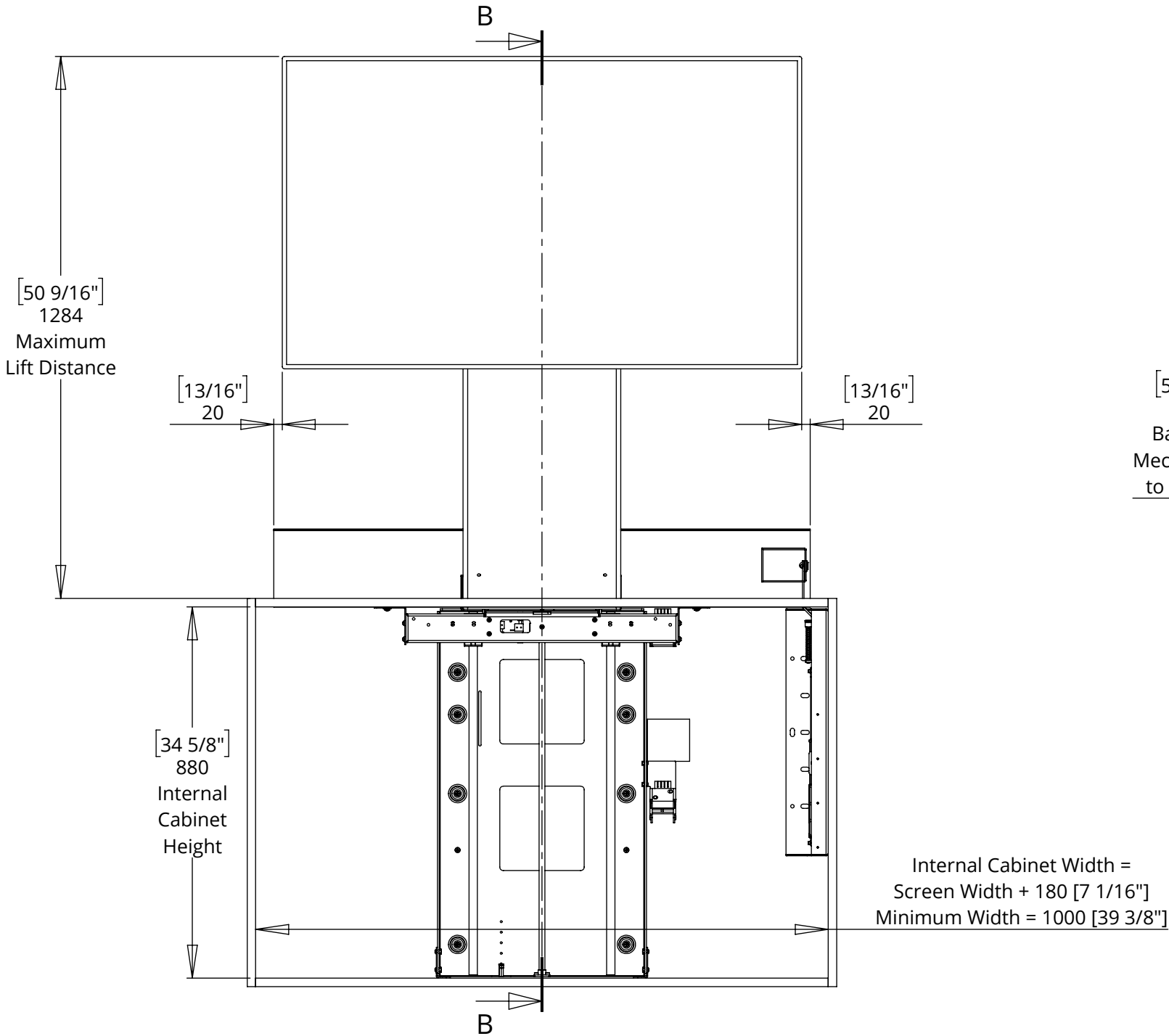
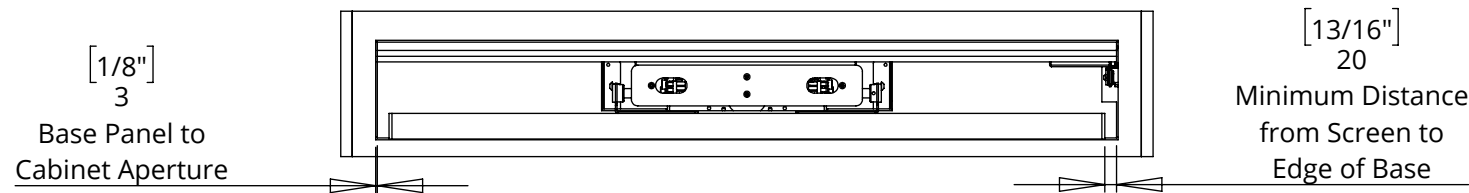

SECTION B-B

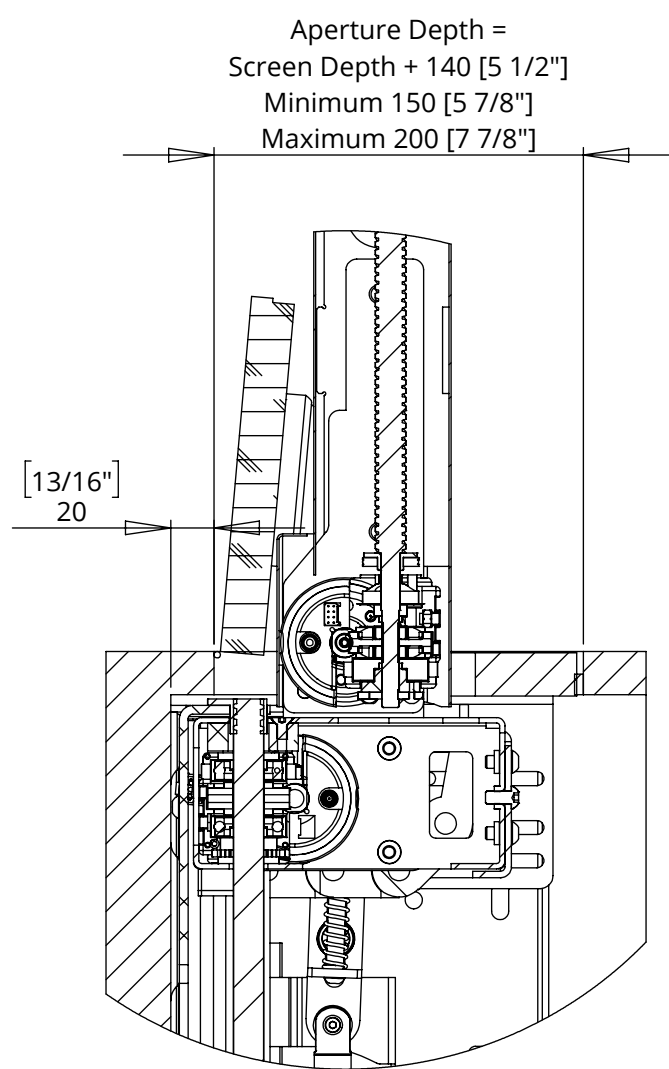

DETAIL C

LSM-TU-HF 5

LIFT SYSTEM TELESCOPIC WITH HEAVY FLAP



future automation

MECHANISM DOWN - IN CABINET

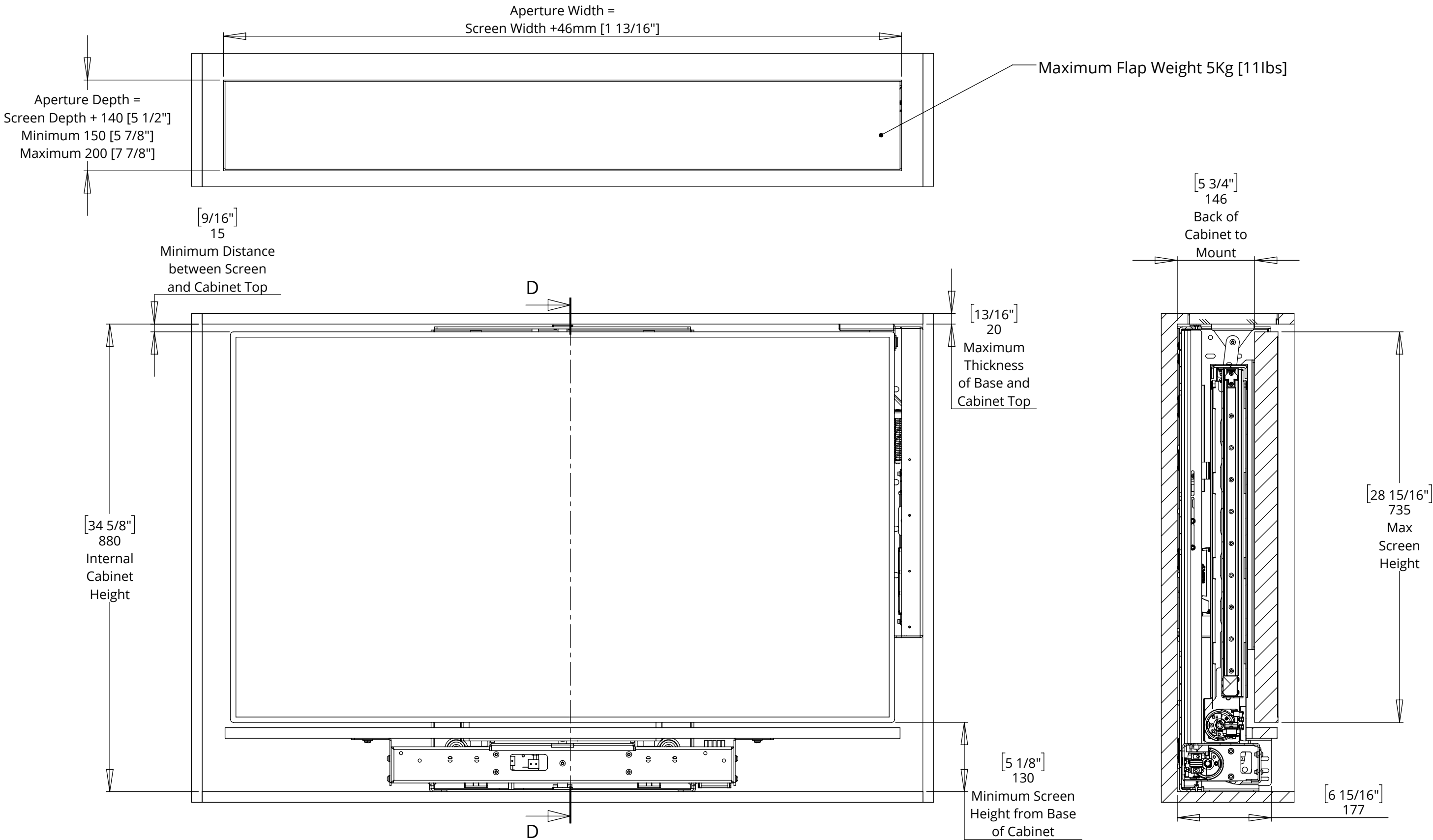

LSM-TU-HF 5

LIFT SYSTEM TELESCOPIC WITH HEAVY FLAP



future automation

BASE PANEL AND FLAP PANEL DETAILS

Flap depth dimensions are based on a 3mm thick piano hinge

Required flap dimensions may vary dependant on the hinge used

IMPORTANT: Flap Panel weight must not exceed 5Kg [11lbs]

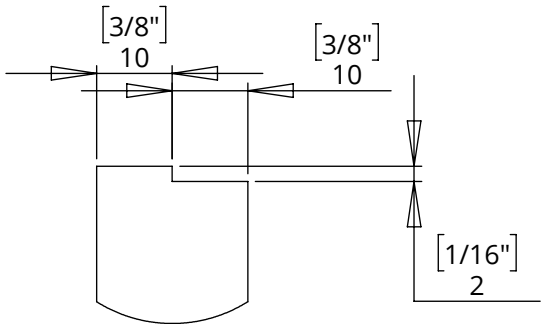

DETAIL E

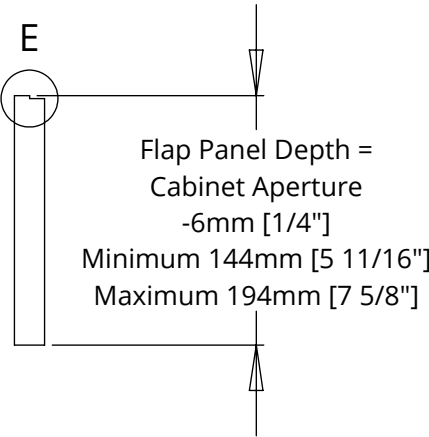

FLAP PANEL



BASE PANEL

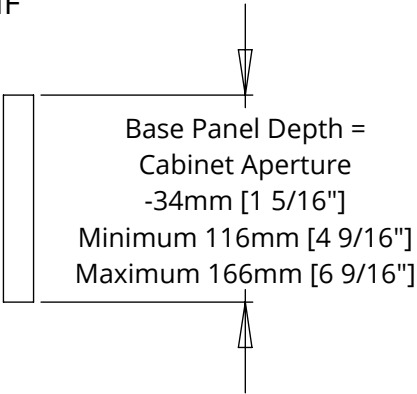
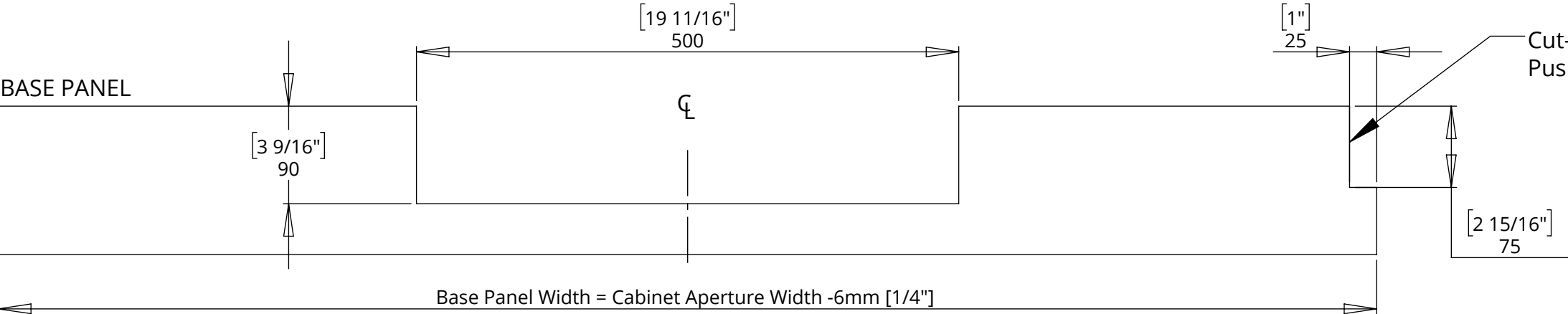

LSM-TU-HF 5

LIFT SYSTEM TELESCOPIC WITH HEAVY FLAP



future automation

SCREEN MOUNT ADJUSTABILITY

A standard adjustable height VESA 400 mount is included. This is also compatible with VESA 300 and 200 mounting patterns

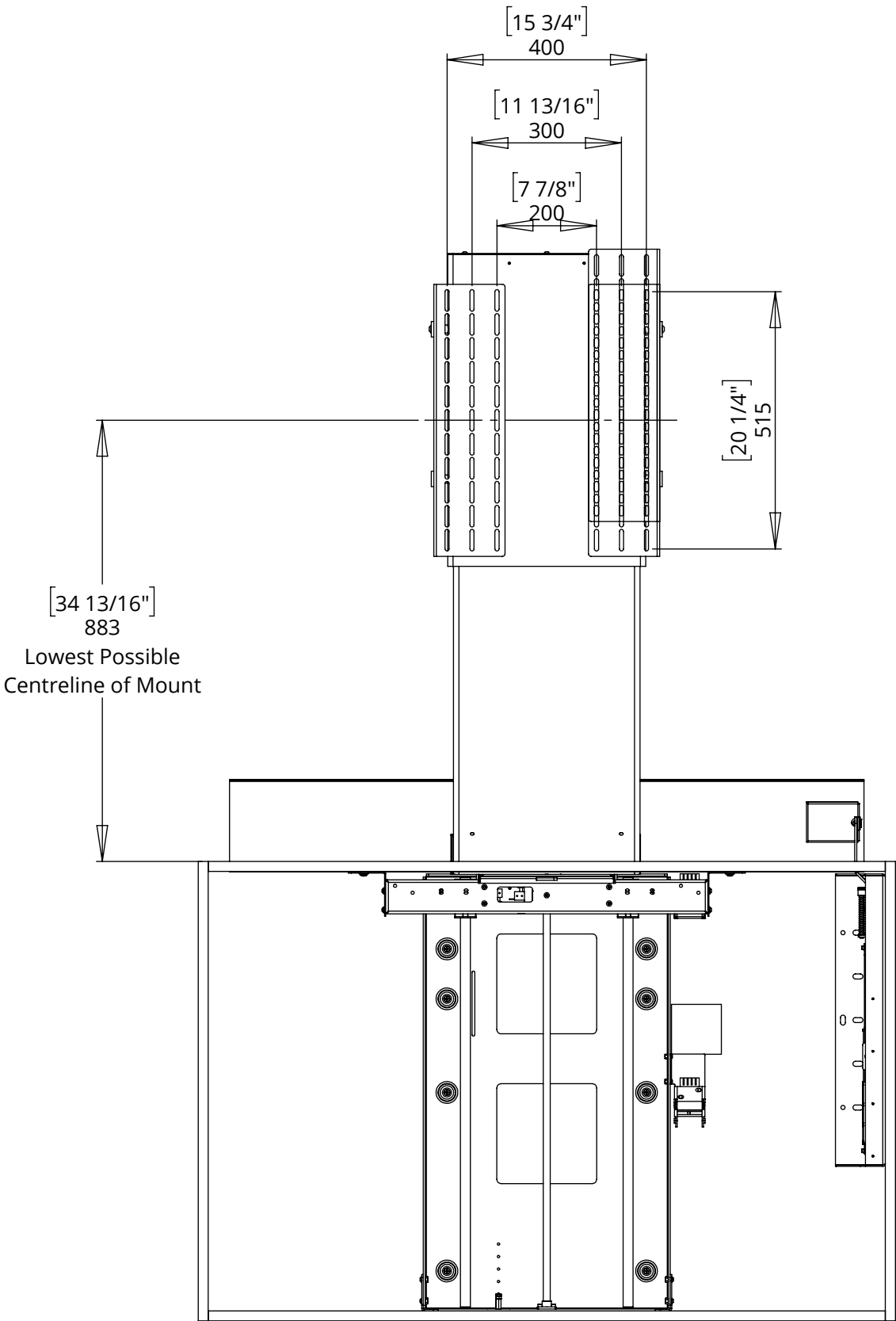
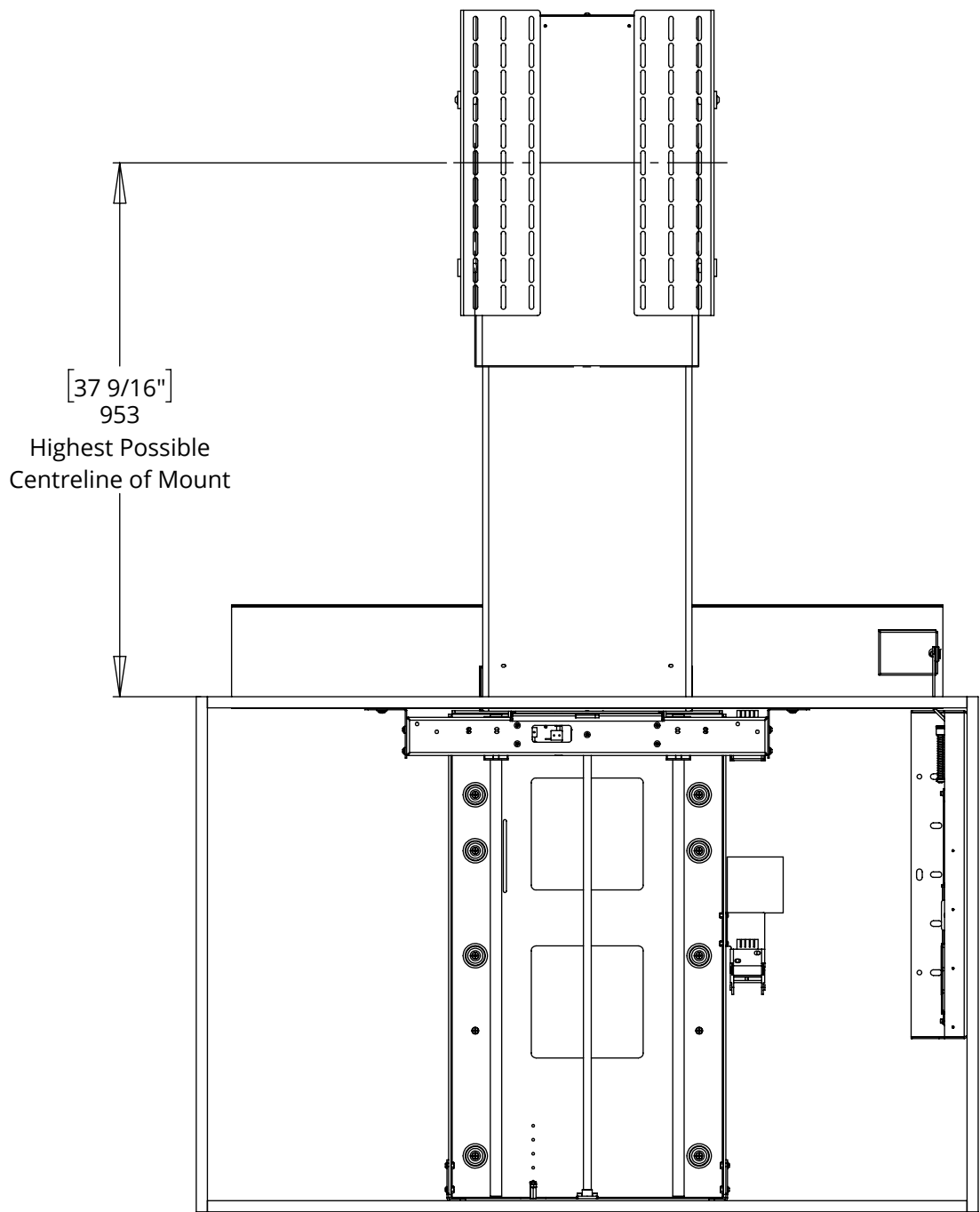

LSM-TU-HF 5

LIFT SYSTEM TELESCOPIC WITH HEAVY FLAP

MECHANISM INSTALLATION OVERVIEW

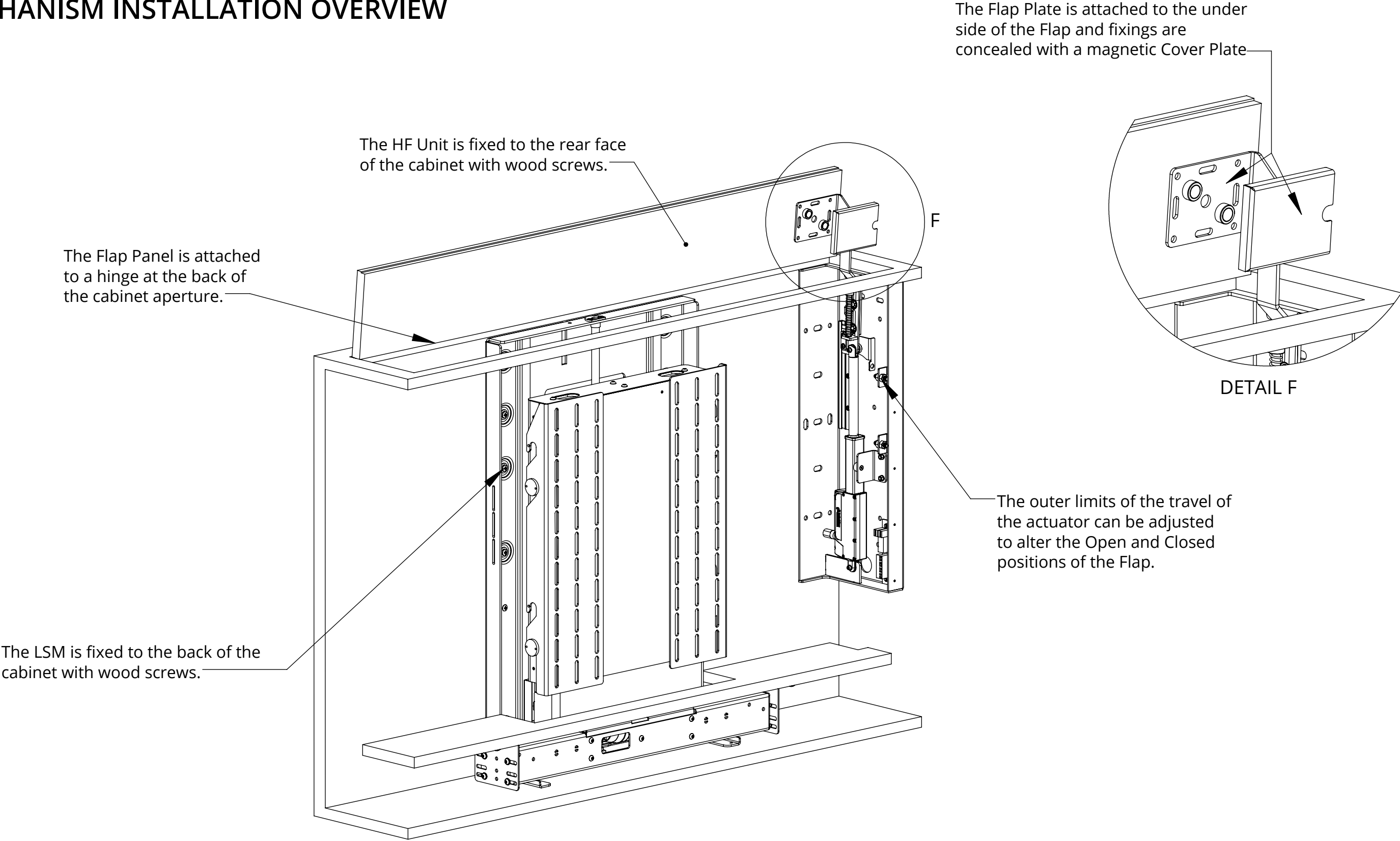

LSM-TU-HF 5

LIFT SYSTEM TELESCOPIC WITH HEAVY FLAP

OVERALL MECHANISM DIMENSIONS

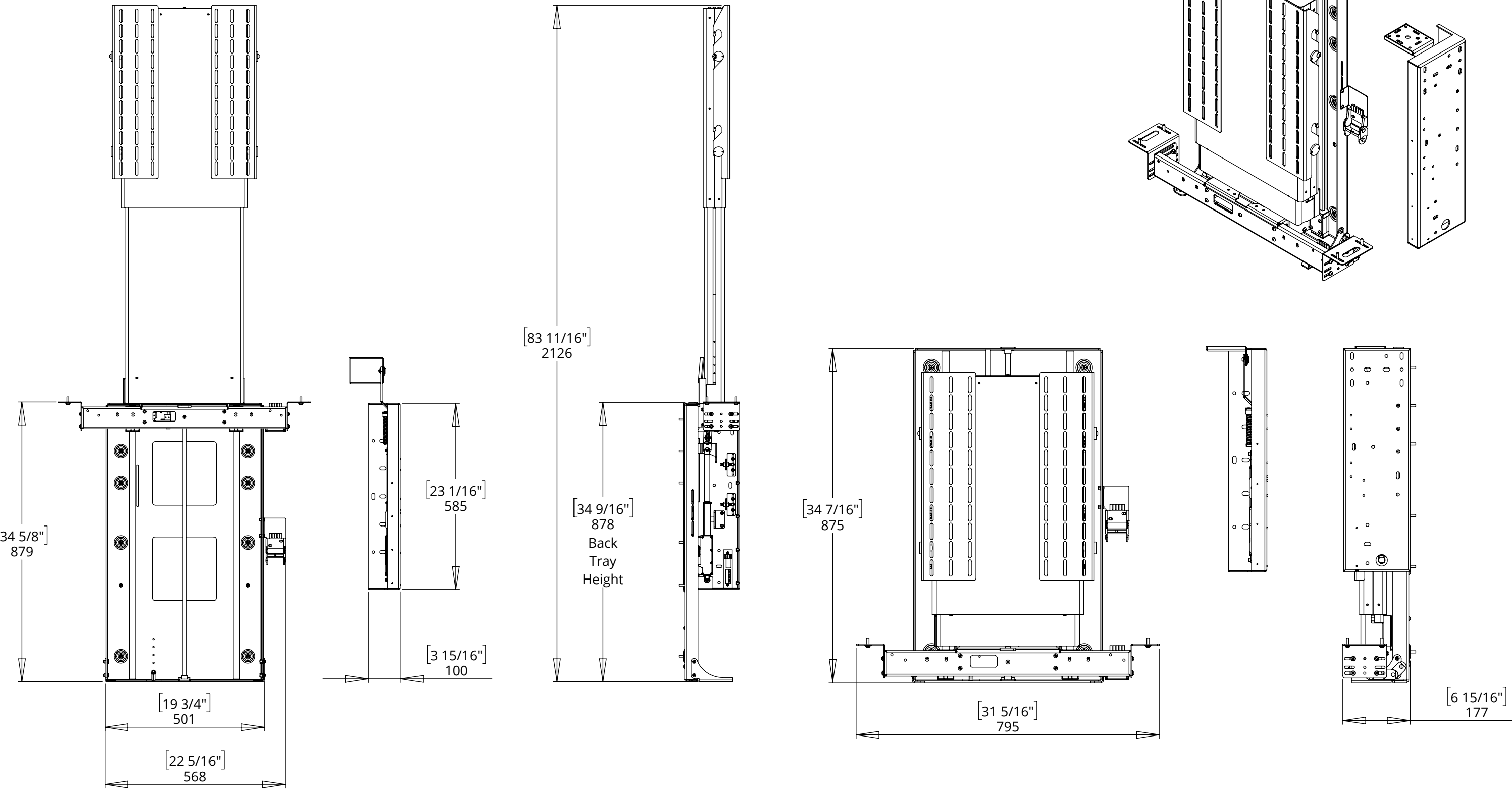

LSM-TU-HF 5

LIFT SYSTEM TELESCOPIC WITH HEAVY FLAP

CONTROL BOX DIMENSIONS

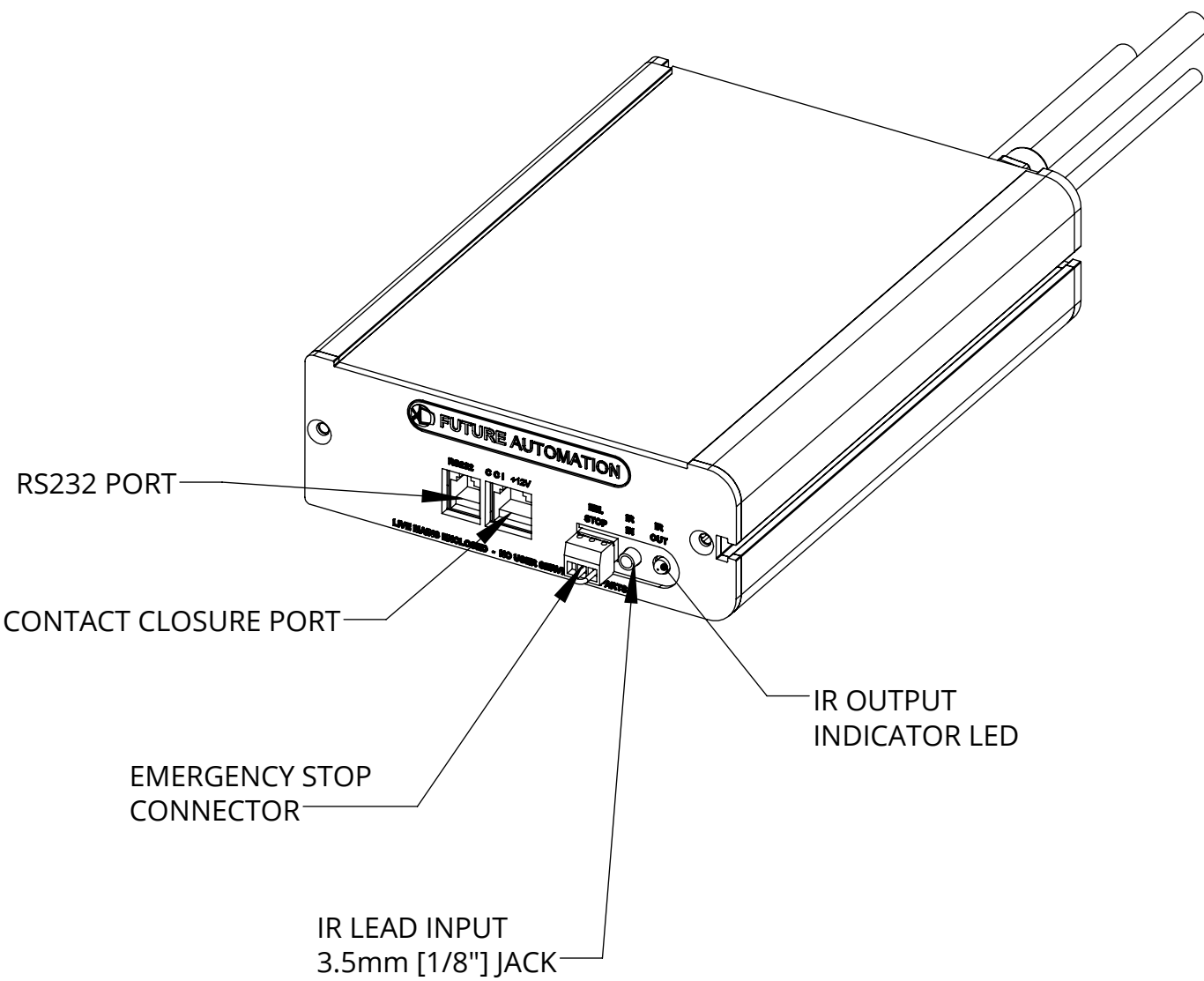
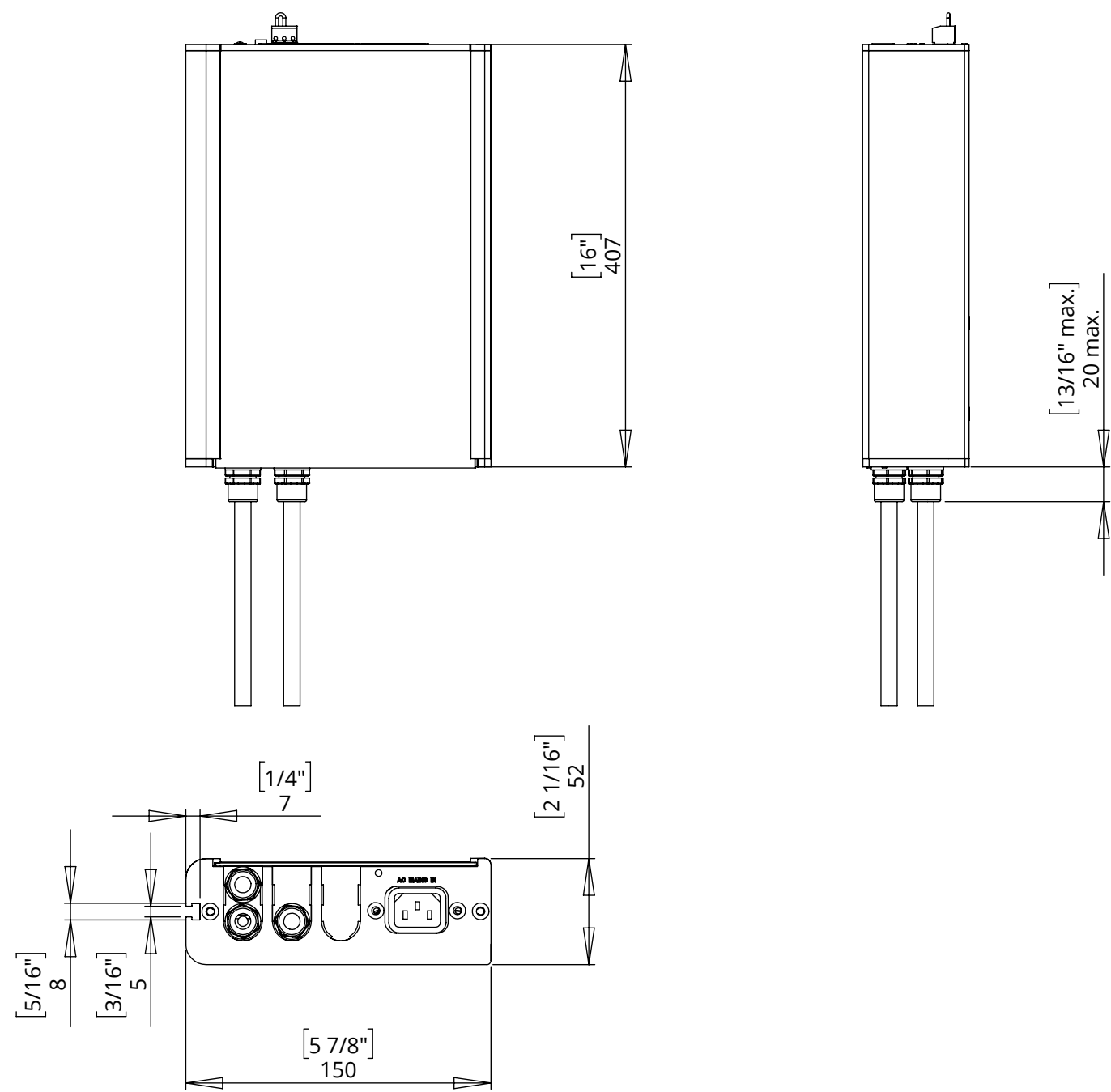

NOTES

CABLE LOOM LENGTH SUPPLIED AT APPROX. 3m [118"]

CONTOL BOX **MUST** BE LOCATED IN ACCESSIBLE LOCATION